

SKETCH of **STEERING LINES** **CAROLINA SPRITSAIL SKIFF .**

Steering lines were preferred to a tiller for at least two reasons.

- 1) Nets were flaked down in the stern, and Lines could be kept out of the way.
- 2) Lines could be handled from just about anywhere in the boat.
You can " Feel " the rudder.

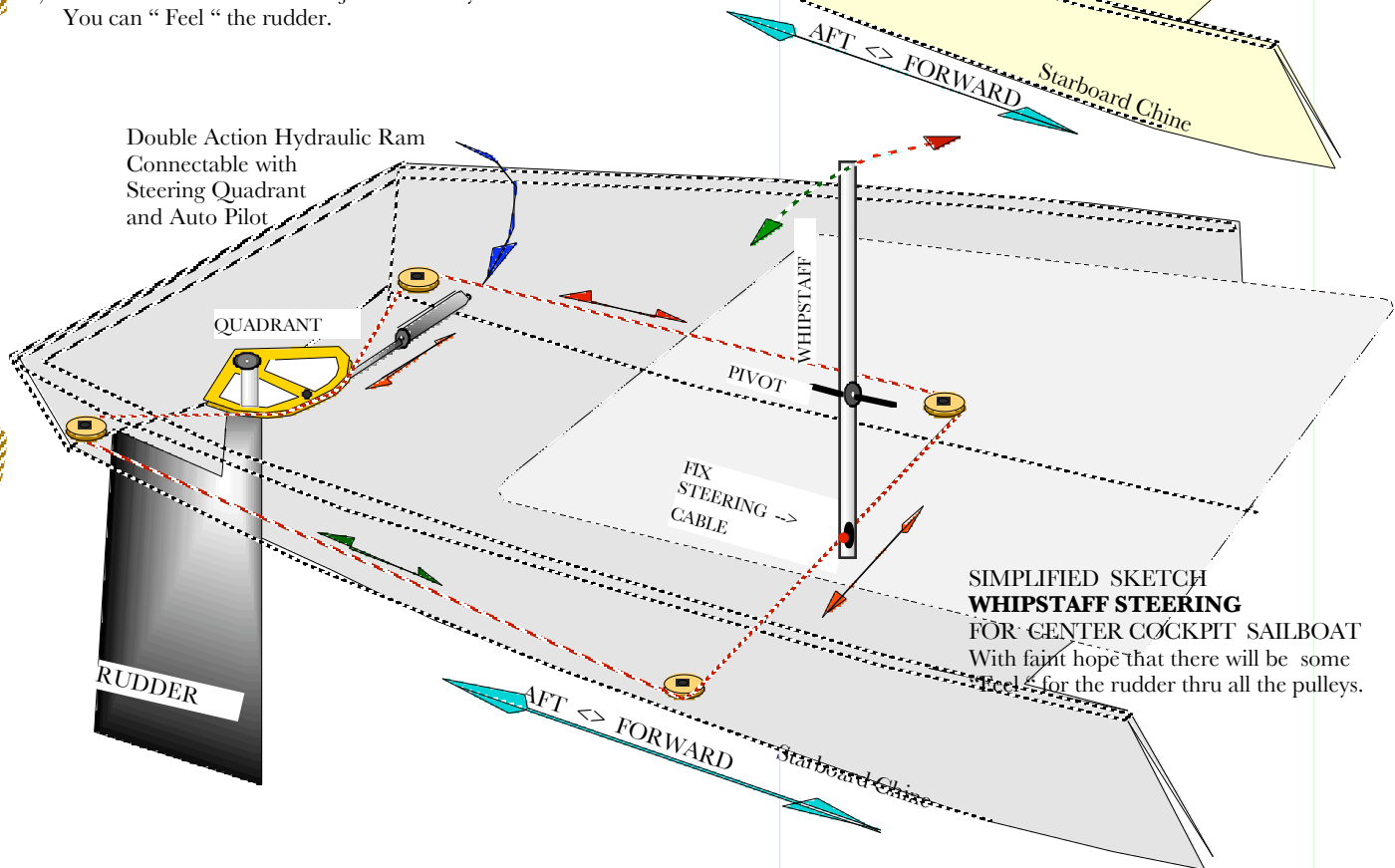

**SIMPLIFIED SKETCH
WHIPSTAFF STEERING**
FOR CENTER COCKPIT SAILBOAT
With faint hope that there will be some
"Feel" for the rudder thru all the pulleys.

Whip Staff Steering

Bill Price 252-247-2112
POB 2112 Morehead City NC USA

4/24/10