

MIDSHIP SECTION
(LOOKING AFT)

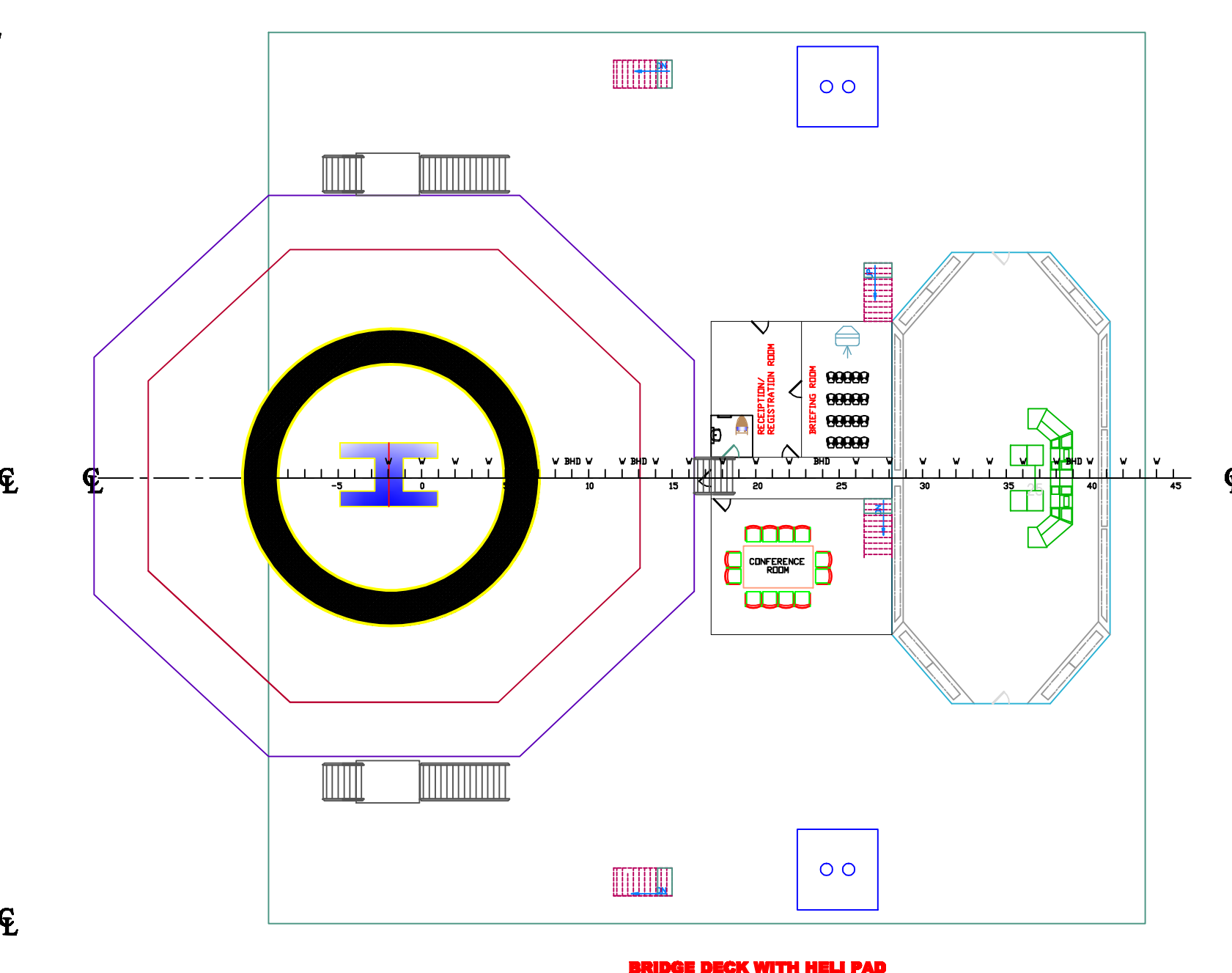

BRIDGE DECK WITH HELI P.



LANDING STATION &
TOP OF PILLARS
17M ABOVE BASE LINE

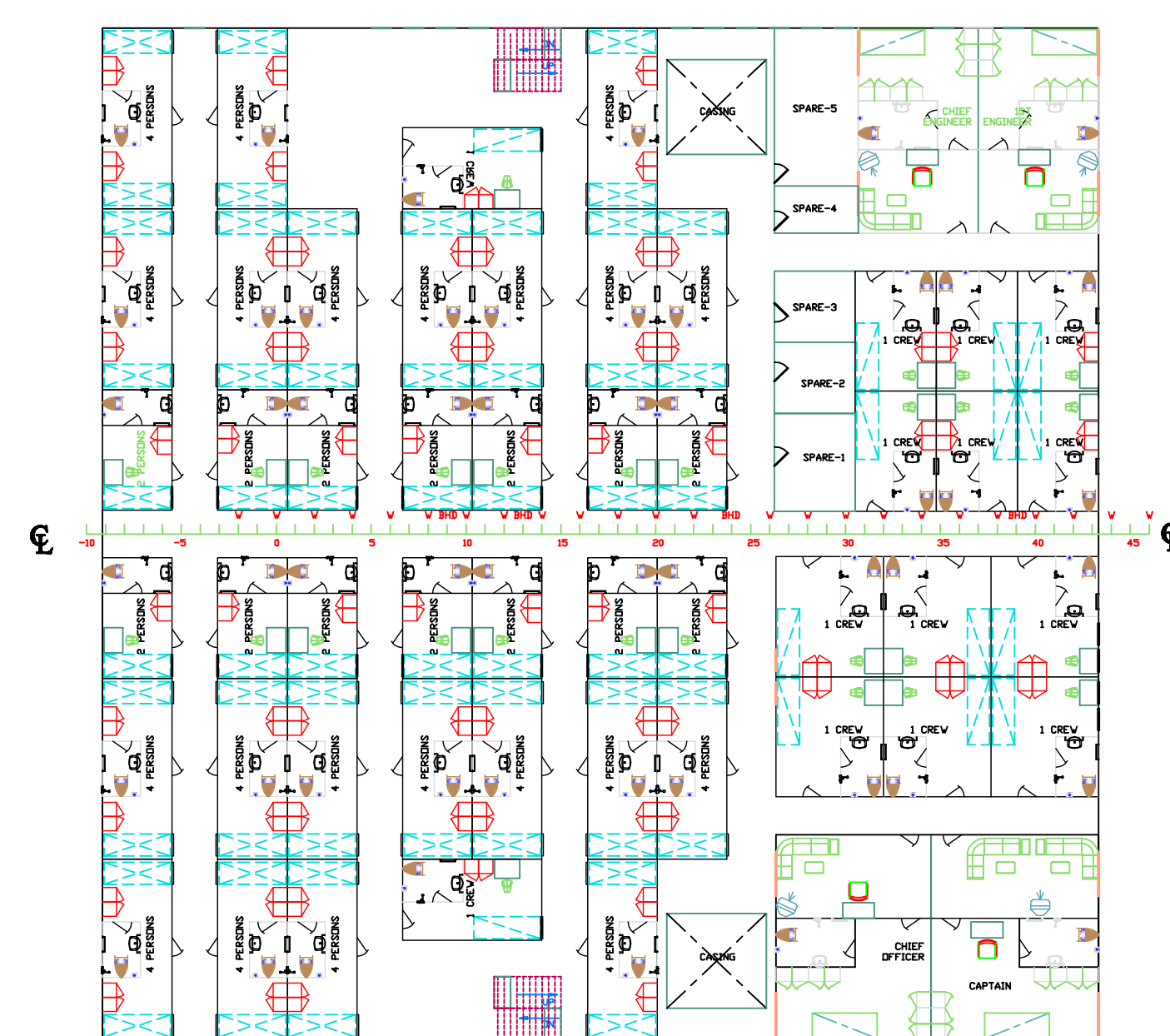

03 DECK

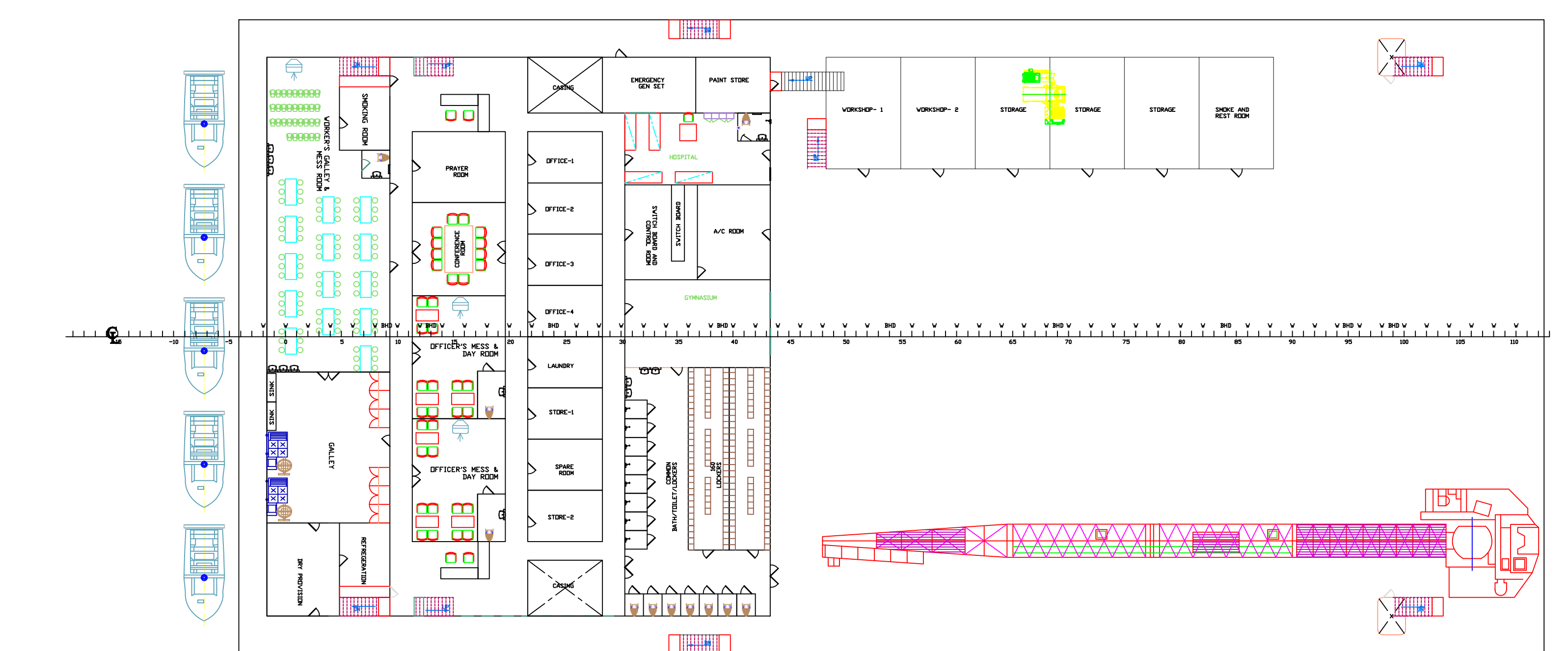

02 DECK

MAIN PARTICULARS

LENGTH O.A	73.00 M
LENGTH P.P	65.40 M
LENGTH WL	73.00 M
BREADTH, MOLDED	42.00 M
BREADTH, R.HULL	10.00M
DEPTH,MOLDED TO MAIN DK.	95.00 M
DEPTH, MOLDED TO PLATFORM DECK	19.50 M
DEPTH OF HELIDECK	29.00 M
DRAUGHT, DESIGN	02.50M
DRAUGHT, SCANTLING	12.50 M
DEADWEIGHT AT DESIGN DRAUGHT	2000T APPROX
MAIN ENGINE OUTPUT (MCR)	41020 KW

CLASS : Germanischer Lloyd

100 A5

SP
MC, AUT

C					
B					
A				24.02.2009	
INDEX	CHANGES			DATE	APPROVE
DESIGN	DATE	NAME	SIGNED	MERMAID MARINE DESIGN LTD. <small>107A, West Coast Road, SINGAPORE, SINGAPORE</small>	
CHECK		S. M. RASHEED HASAN		YARD NO:	PROJECT NO:
APPROVE		MURIL HAYDAR PENCE		1011	SY 257
SCALE:	<div style="text-align: center;"> SWOPU GENERAL ARRANGEMENT PLAN </div>			REF. DRW:	DRW. NO:
1300				FILE:	DWG 01
					SHEETS:
					1/1