

2003-2008 Floating home/windlab/office/studio/gatheringplace San Pedro

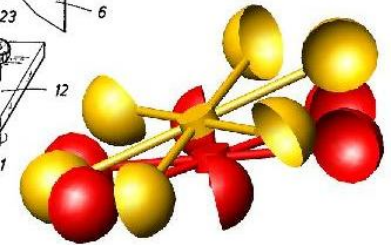
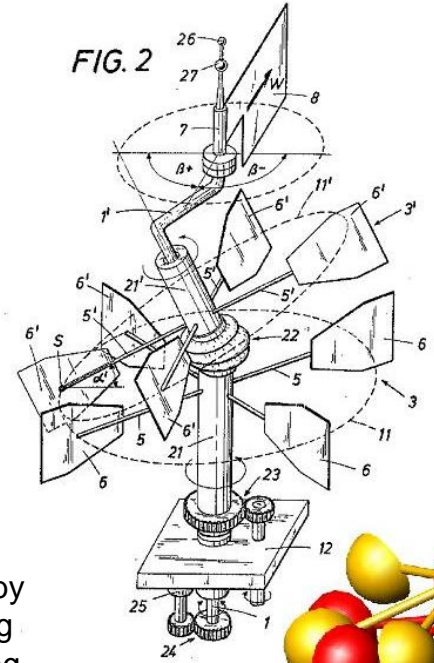
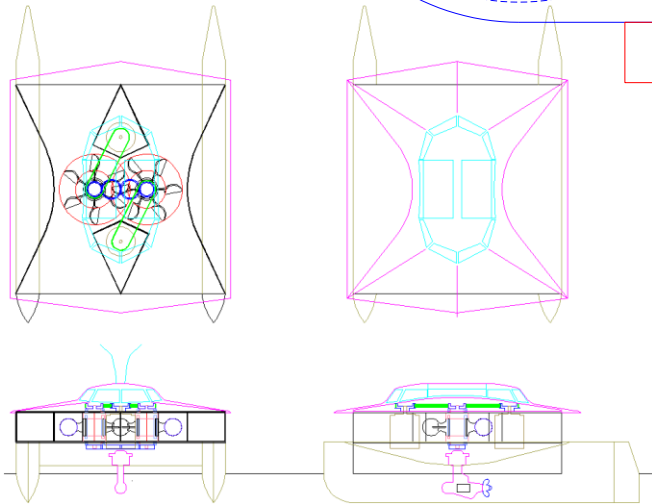
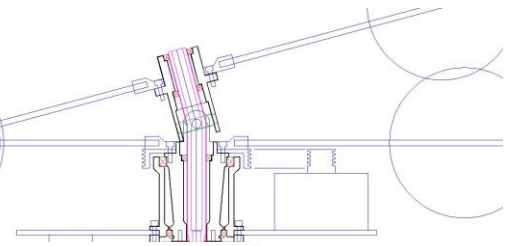
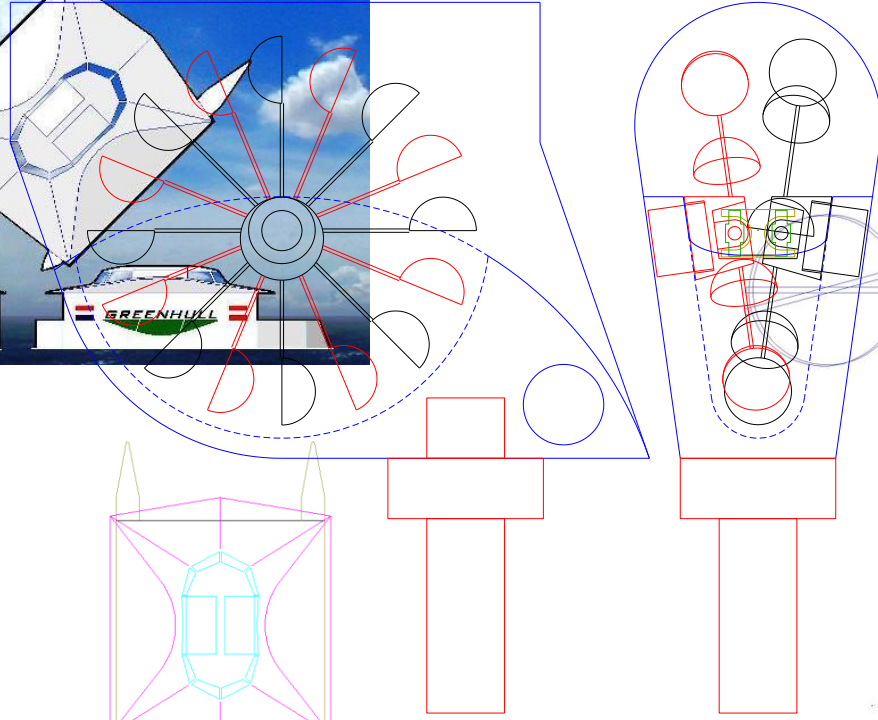
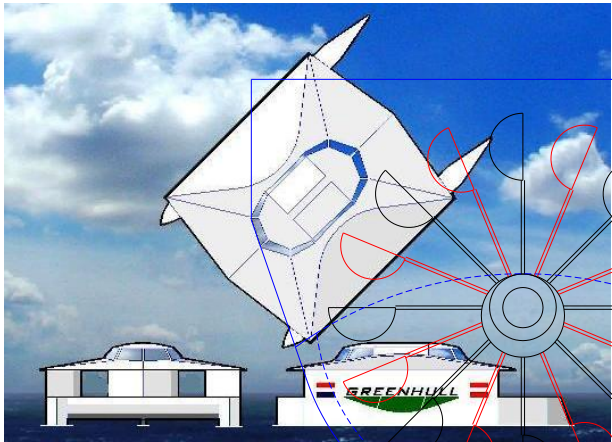

In 2007 an internet acquaintance introduced me to a wind turbine design by an Austrian inventor that used inter-digitized cups that shield the returning cups by tucking in behind each other on the upwind leg, and then exposing the cup on the downwind leg. Since the concept uses the drag on the cups to drive them, there are no other forces to consider, and in theory could yield a good power profile, but has the disadvantage of mechanical complexity. It does have the advantage of not creating adverse thrust that opposes the driving force of props and drive wheels.