



# Miscellaneous Extrusions

- ▶ Marine and Miscellaneous Extrusions



# Marine and Miscellaneous Extrusions

## Deckings

SECTIONS NOT TO SCALE

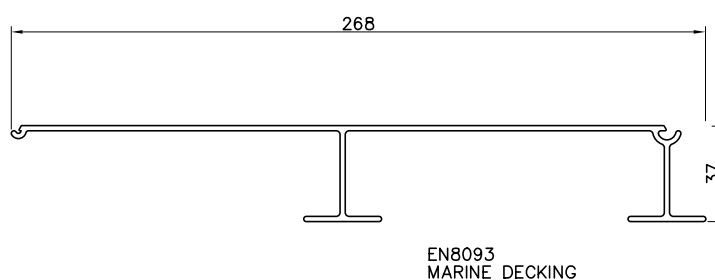
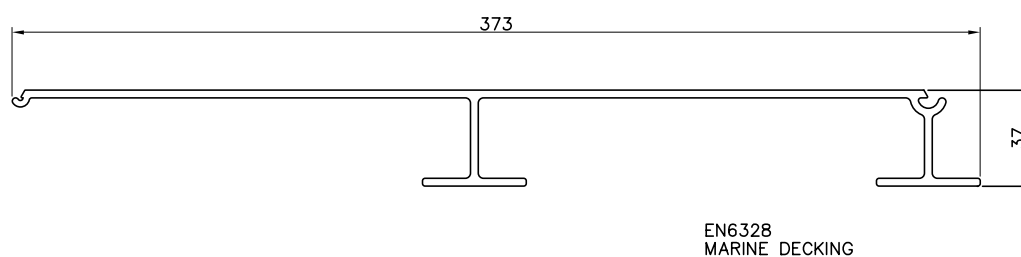
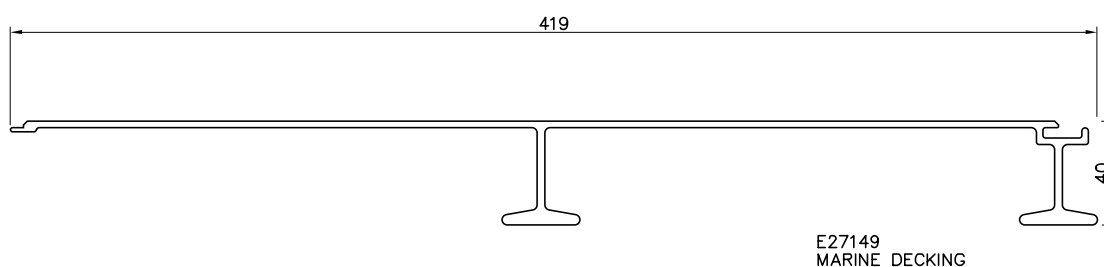

Extrusion No.	Alloy/ Temper	Mass per metre kg/m	Area of Section mm <sup>2</sup>	Anodising Perimeter mm	Moment of Inertia (I)		Section Modulus (Z)		Radius of Gyration (k)	
					about x-x mm <sup>4</sup>	about y-y mm <sup>4</sup>	about x-x mm <sup>3</sup>	about y-y mm <sup>3</sup>	about x-x mm	about y-y mm
E27149	6082 T6	4.184	1550	1089	328830	23547780	11128	97932	14.57	123.26
EN6328	6351 T6	4.111	1522	1007	261400	17567460	9376	85955	13.11	107.44
EN8093	6351 T6	2.107	780	771	143980	4661440	5232	31327	13.59	77.31

## Deckings (cont)

SECTIONS NOT TO SCALE

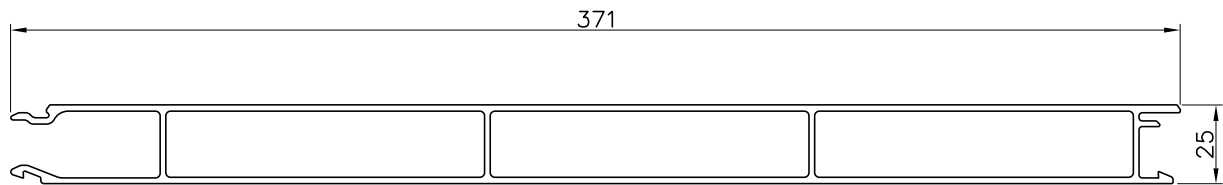

EP4034  
DECK EXTRUSION

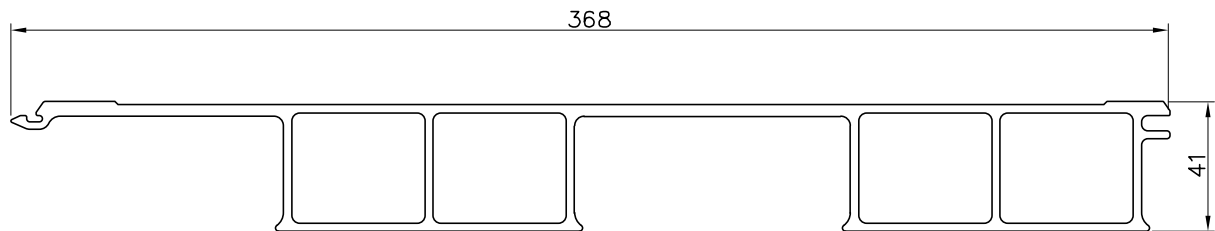

EP2953  
CAR DECK EXTRUSIO

Extrusion No.	Alloy/ Temper	Mass per metre kg/m	Area of Section mm <sup>2</sup>	Anodising Perimeter mm	Moment of Inertia (I)		Section Modulus (Z)		Radius of Gyration (k)	
					about x-x mm <sup>4</sup>	about y-y mm <sup>4</sup>	about x-x mm <sup>3</sup>	about y-y mm <sup>3</sup>	about x-x mm	about y-y mm
EP4034	6005A T5	4.520	1674	929	202270	20174420	13566	107965	10.99	109.78
EP2953	6082 T6	6.244	2312	920	57711	26201950	26534	131036	15.80	106.46

## Floor / Starter Planks

HALF SIZE SECTIONS

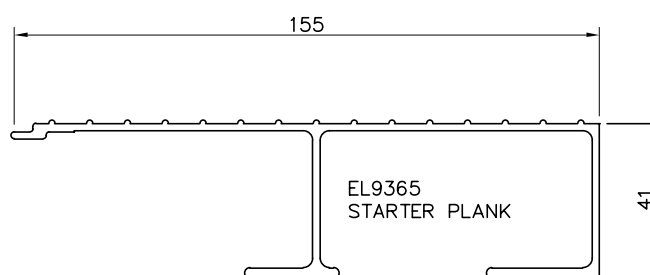
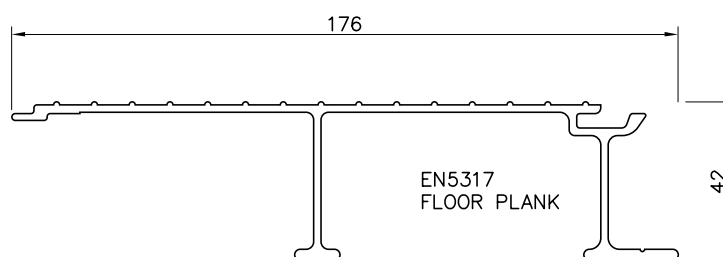
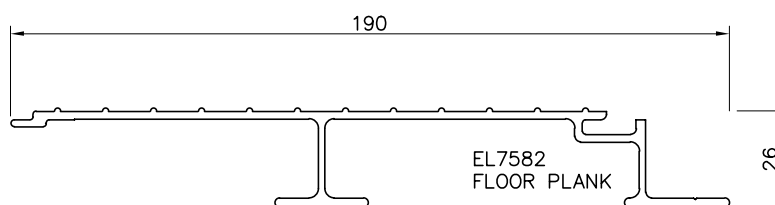
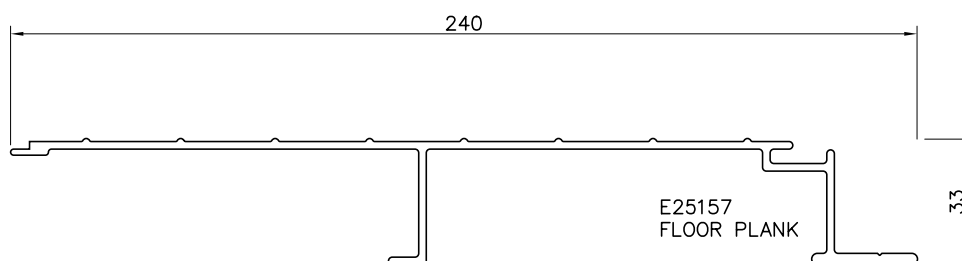

Extrusion No.	Alloy/ Temper	Mass per metre kg/m	Area of Section mm <sup>2</sup>	Anodising Perimeter mm	Moment of Inertia (I)		Section Modulus (Z)		Radius of Gyration (k)	
					about x-x mm <sup>4</sup>	about y-y mm <sup>4</sup>	about x-x mm <sup>3</sup>	about y-y mm <sup>3</sup>	about x-x mm	about y-y mm
E25157	6082 T5	1.847	684	645	90000	3336000	3714	25036	11.47	69.84
EL7582	6351 T5	1.597	591	551	55130	1649620	3172	16198	9.66	52.83
EN5317	6351 T5	1.701	630	578	148160	1600350	5314	15593	15.34	50.40
EL9365	6106 T6	1.738	644	580	181550	1315450	6956	14849	16.79	45.20

# Gunwales

## FULL SIZE SECTIONS

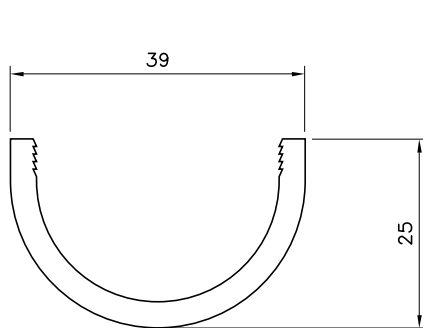

EU9824  
GUNWALE SECTION

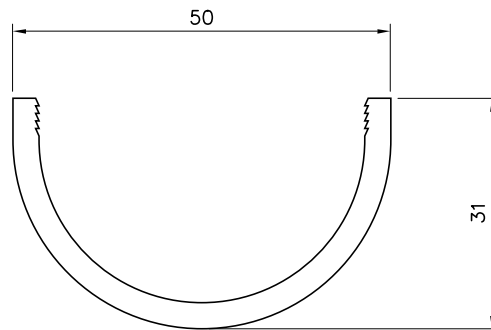

EA3052  
GUNWALE SECTION

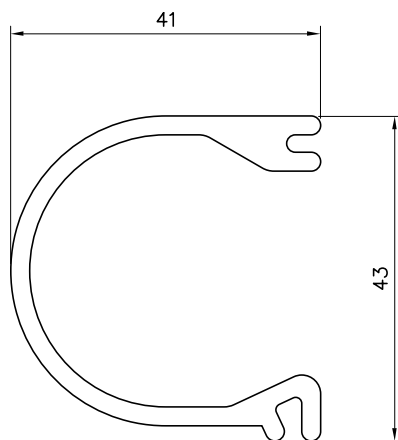

EB4549  
GUNWALE SECTION

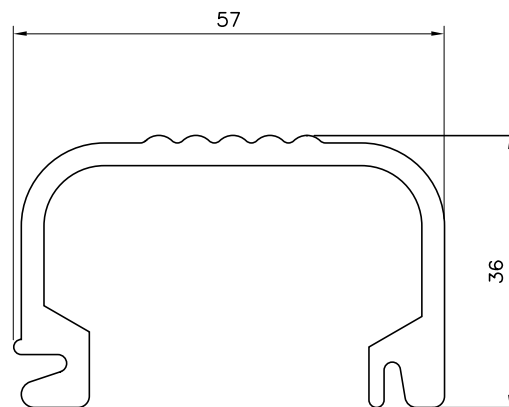

EU3862  
GUNWALE SECTION

Extrusion No.	Alloy/ Temper	Mass per metre kg/m	Area of Section mm <sup>2</sup>	Anodising Perimeter mm	Moment of Inertia (I)		Section Modulus (Z)		Radius of Gyration (k)	
					about x-x mm <sup>4</sup>	about y-y mm <sup>4</sup>	about x-x mm <sup>3</sup>	about y-y mm <sup>3</sup>	about x-x mm	about y-y mm
EU9824	6106 T6	0.617	228	144	11950	42160	816	2162	7.24	13.60
EA3052	6061 T6	0.777	287	176	21850	87010	1221	3480	8.73	17.41
EB4549	6060 T5	0.878	325	236	85200	58520	3701	2754	16.19	13.42
EU3862	6106 T4	1.234	457	270	70210	210150	3397	7468	12.39	21.44

## Gunwales (cont)

### FULL SIZE SECTIONS

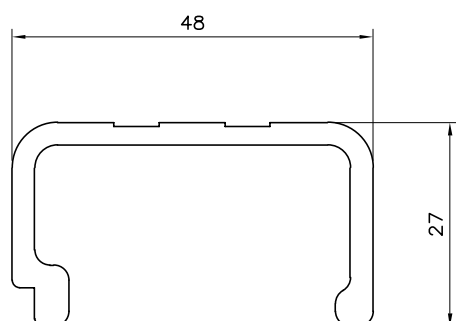

EQ3279  
GUNWALE SECTION

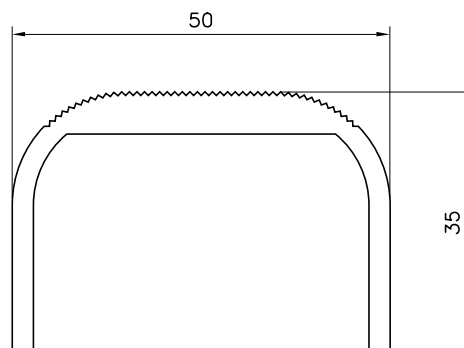

EL1925  
GUNWALE SECTION

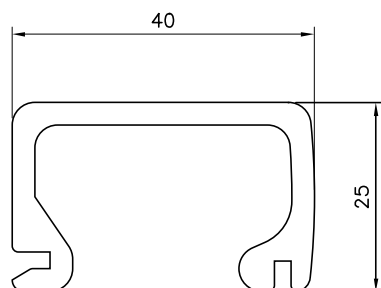

EU4552  
GUNWALE SECTION

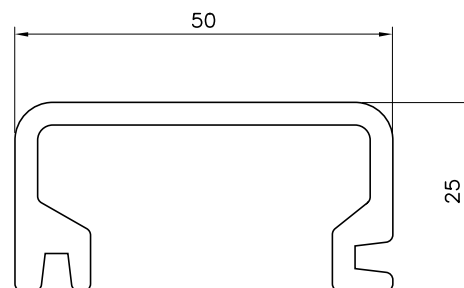

E53192  
GUNWALE SECTION

Extrusion No.	Alloy/ Temper	Mass per metre kg/m	Area of Section mm <sup>2</sup>	Anodising Perimeter mm	Moment of Inertia (I)		Section Modulus (Z)		Radius of Gyration (k)	
					about x-x mm <sup>4</sup>	about y-y mm <sup>4</sup>	about x-x mm <sup>3</sup>	about y-y mm <sup>3</sup>	about x-x mm	about y-y mm
EQ3279	6060 T5	0.803	297	198	23690	100470	1396	4113	8.93	18.39
EL9125	6106 T4	0.972	360	225	37180	112280	1566	4491	10.16	17.66
EU4552	6060 T5	0.842	311	196	22670	70760	1565	3536	8.54	15.08
E53192	6060 T5	0.960	355	220	25280	125970	1715	4828	8.44	18.84

## Gunwales (cont)

### FULL SIZE SECTIONS

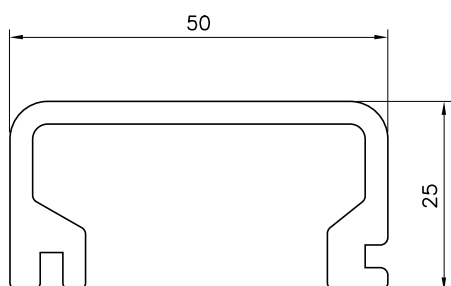

E51892  
GUNWALE SECTION

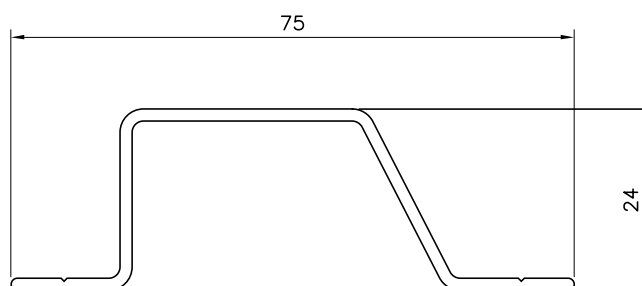

E61824  
GUNWALE SECTION

Extrusion No.	Alloy/ Temper	Mass per metre kg/m	Area of Section mm <sup>2</sup>	Anodising Perimeter mm	Moment of Inertia (I)		Section Modulus (Z)		Radius of Gyration (k)	
					about x-x mm <sup>4</sup>	about y-y mm <sup>4</sup>	about x-x mm <sup>3</sup>	about y-y mm <sup>3</sup>	about x-x mm	about y-y mm
E51892	6060 T5	0.973	360	222	25950	128240	1779	4923	8.49	18.87
E61824	6061 T6	0.464	171	218	15220	73970	1266	1867	9.43	20.80

## Gunwales (cont)

FULL SIZE SECTIONS

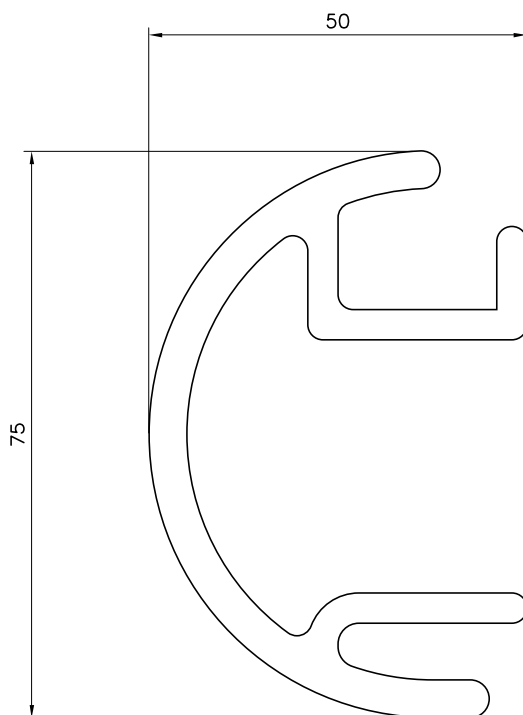

E72032  
GUNWALE

Extrusion No.	Alloy/ Temper	Mass per metre kg/m	Area of Section mm <sup>2</sup>	Anodising Perimeter mm	Moment of Inertia (I)		Section Modulus (Z)		Radius of Gyration (k)	
					about x-x mm <sup>4</sup>	about y-y mm <sup>4</sup>	about x-x mm <sup>3</sup>	about y-y mm <sup>3</sup>	about x-x mm	about y-y mm
E72032	6061 T6	2.493	923	396	529270	187410	14013	7014	23.95	14.25

# Chines

## FULL SIZE SECTIONS

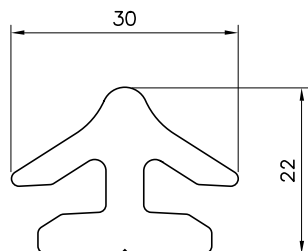

EL6422  
CHINE

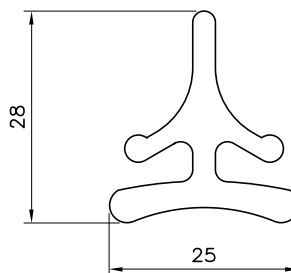

EB465°  
CHINE

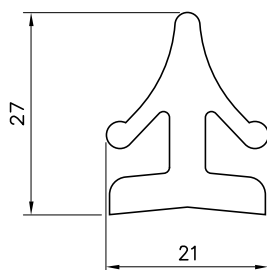

EU4601  
CHINE

Extrusion No.	Alloy/ Temper	Mass per metre kg/m	Area of Section mm <sup>2</sup>	Anodising Perimeter mm	Moment of Inertia (I)		Section Modulus (Z)		Radius of Gyration (k)	
					about x-x mm <sup>4</sup>	about y-y mm <sup>4</sup>	about x-x mm <sup>3</sup>	about y-y mm <sup>3</sup>	about x-x mm	about y-y mm
EL6422	6060 T591	0.827	306	127	10880	12340	851	823	5.96	6.35
EB4659	6060 T5	0.622	230	130	10880	7430	587	594	6.88	5.68
EU4601	6060 T5	0.686	253	124	12310	6110	742	592	6.98	4.91

# Keels

## FULL SIZE SECTIONS

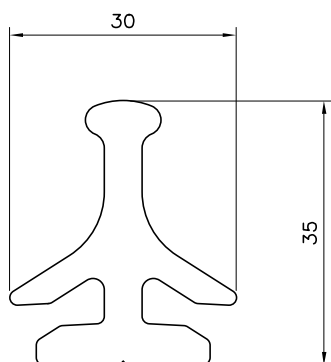
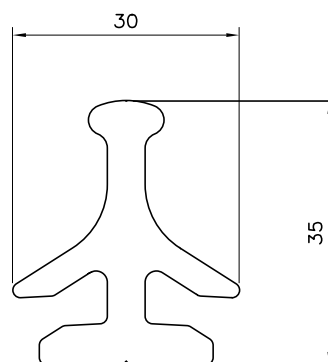
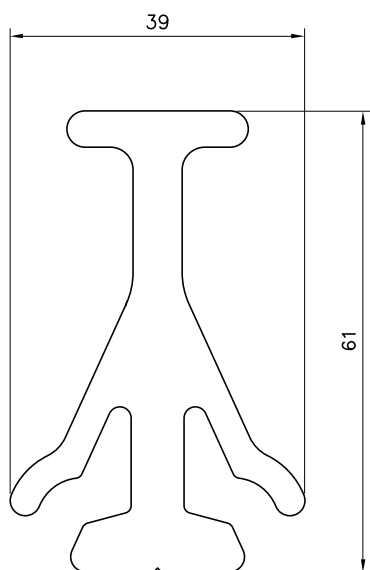
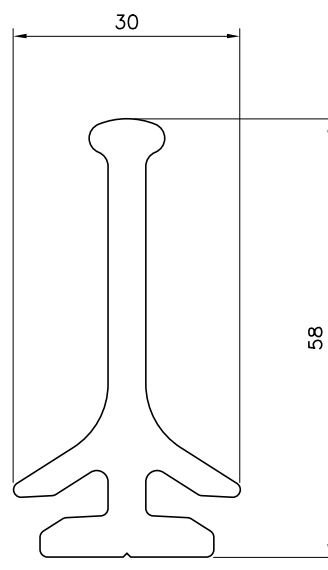
 EL6077  
KEEL

 EL6421  
KEEL

 EL6051  
KEEL

 EL6052  
KEEL

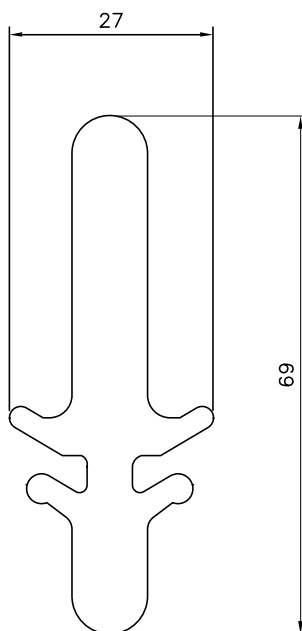
Extrusion No.	Alloy/ Temper	Mass per metre kg/m	Area of Section mm <sup>2</sup>	Anodising Perimeter mm	Moment of Inertia (I)		Section Modulus (Z)		Radius of Gyration (k)	
					about x-x mm <sup>4</sup>	about y-y mm <sup>4</sup>	about x-x mm <sup>3</sup>	about y-y mm <sup>3</sup>	about x-x mm	about y-y mm
EL6077	6060 T5	1.065	394	158	38550	12740	1776	849	9.89	5.69
EL6421	6060 T5	1.065	394	158	38400	12740	1793	849	9.87	5.69
EL6051	6060 T5	2.294	849	271	295940	40960	8595	2101	18.67	6.95
EL6052	6060 T5	1.376	509	204	159760	12980	4385	865	17.72	5.05

## Keels (cont)

FULL SIZE SECTIONS



E17681  
KEEL

Extrusion No.	Alloy/ Temper	Mass per metre kg/m	Area of Section mm <sup>2</sup>	Anodising Perimeter mm	Moment of Inertia (I)		Section Modulus (Z)		Radius of Gyration (k)	
					about x-x mm <sup>4</sup>	about y-y mm <sup>4</sup>	about x-x mm <sup>3</sup>	about y-y mm <sup>3</sup>	about x-x mm	about y-y mm
E17681	6060 T5	2.047	758	206	255740	13180	7196	976	18.37	4.17

# Masts

## HALF SIZE SECTIONS

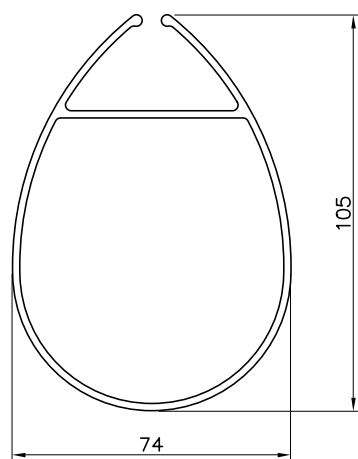

EL1902  
YATCH MAST

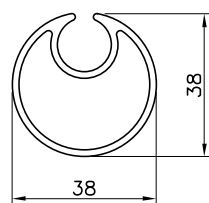

EL2600  
YATCH MAST

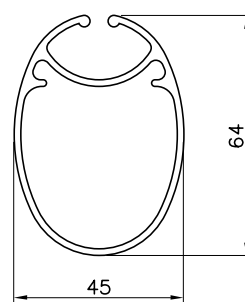

EK4620  
YATCH MAST

Extrusion No.	Alloy/ Temper	Mass per metre kg/m	Area of Section mm <sup>2</sup>	Anodising Perimeter mm	Moment of Inertia (I)		Section Modulus (Z)		Radius of Gyration (k)	
					about x-x mm <sup>4</sup>	about y-y mm <sup>4</sup>	about x-x mm <sup>3</sup>	about y-y mm <sup>3</sup>	about x-x mm	about y-y mm
EL1902	6061 T5	1.659	615	387	667560	372870	12471	10124	32.95	24.62
EL2600	6106 T6	0.708	262	157	36170	35950	1741	1887	11.75	11.71
EK4620	6106 T6	1.042	386	236	149090	90790	4195	4043	19.65	15.33

## Masts (cont)

HALF SIZE SECTIONS

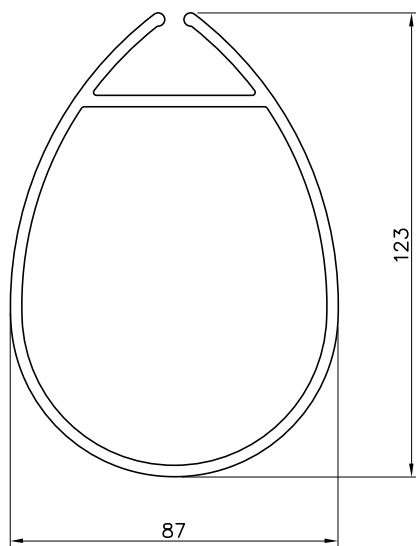

EL1901  
YATCH MAST

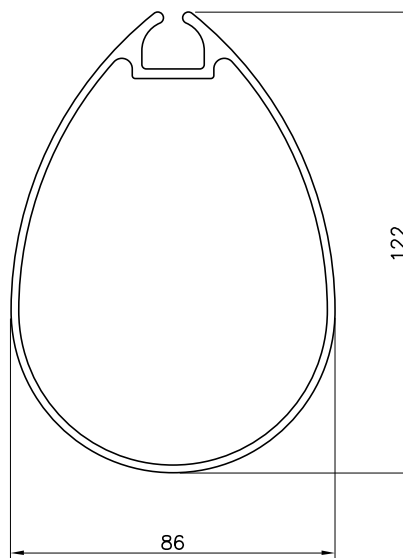

EH4960  
YATCH MAST

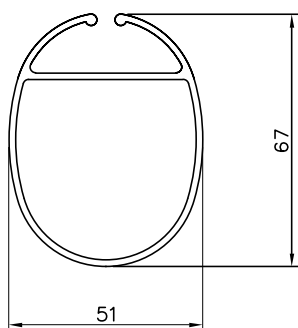

EK4621  
YATCH MAST

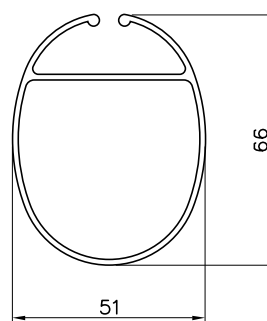

E11466  
YATCH MAST

Extrusion No.	Alloy/ Temper	Mass per metre kg/m	Area of Section mm <sup>2</sup>	Anodising Perimeter mm	Moment of Inertia (I)		Section Modulus (Z)		Radius of Gyration (k)	
					about x-x mm <sup>4</sup>	about y-y mm <sup>4</sup>	about x-x mm <sup>3</sup>	about y-y mm <sup>3</sup>	about x-x mm	about y-y mm
EL1901	6061 T5	2.944	1090	424	1690520	909170	27057	20973	39.38	28.88
EH4960	6061 T6	2.069	766	369	1285870	595010	19692	13879	40.97	27.87
EK4621	6106 T6	1.072	397	277	179860	123230	4926	4808	21.28	17.62
E11466	6061 T6	0.922	341	276	152920	104060	4201	4097	21.18	17.47

## Masts (cont)

HALF SIZE SECTIONS

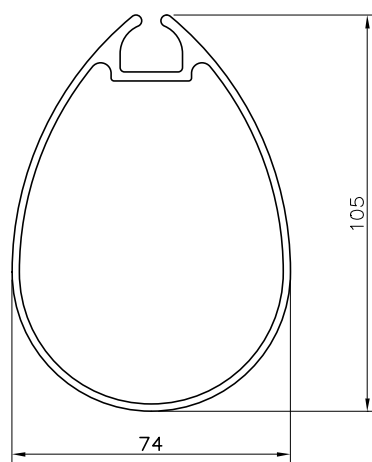
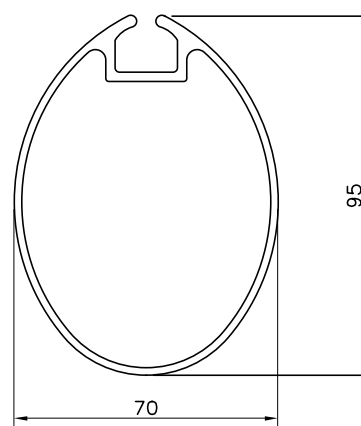
 EH4959  
YACHT MAST

 K3672  
YACHT MAST

Extrusion No.	Alloy/ Temper	Mass per metre kg/m	Area of Section mm <sup>2</sup>	Anodising Perimeter mm	Moment of Inertia (I)		Section Modulus (Z)		Radius of Gyration (k)	
					about x-x mm <sup>4</sup>	about y-y mm <sup>4</sup>	about x-x mm <sup>3</sup>	about y-y mm <sup>3</sup>	about x-x mm	about y-y mm
EH4959	6061 T5	1.727	639	324	781870	358150	13693	9724	34.98	23.67
EK3672	6061 T5	1.671	619	303	614580	310540	11443	8892	31.51	22.40

## Masts (cont)

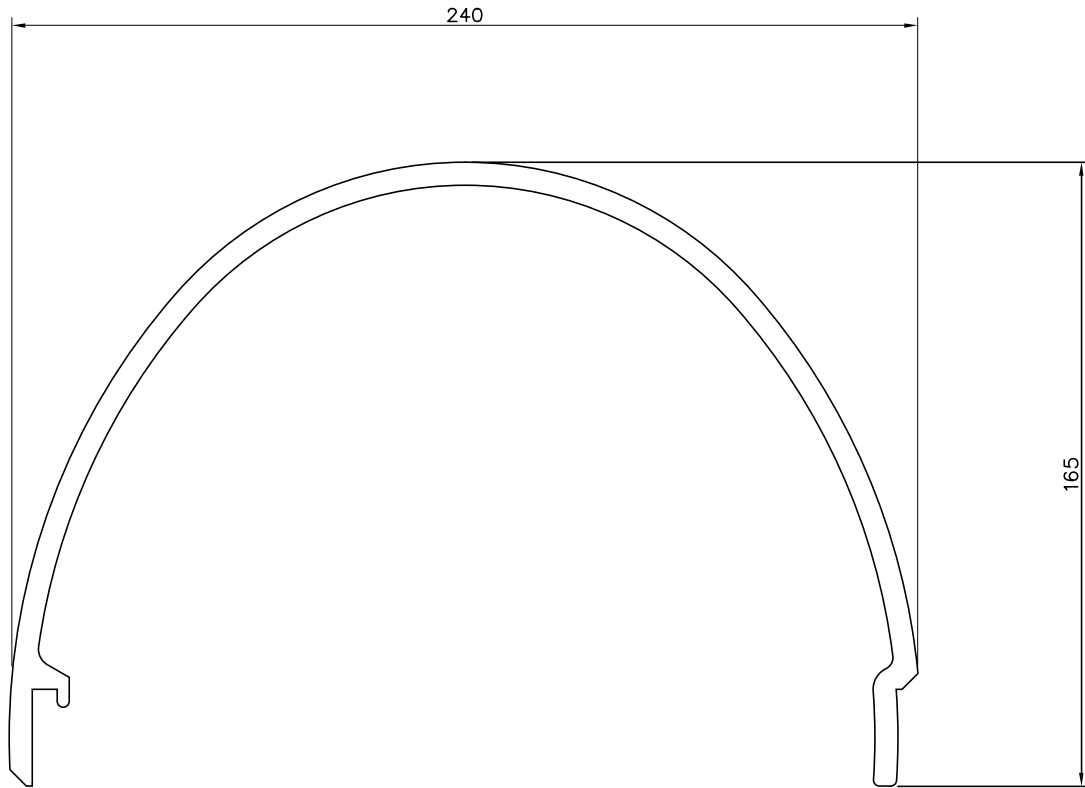
HALF SIZE SECTIONS



EH7663  
SELF INTERLOCKING MAST

Extrusion No.	Alloy/ Temper	Mass per metre kg/m	Area of Section mm <sup>2</sup>	Anodising Perimeter mm	Moment of Inertia (I)		Section Modulus (Z)		Radius of Gyration (k)	
					about x-x mm <sup>4</sup>	about y-y mm <sup>4</sup>	about x-x mm <sup>3</sup>	about y-y mm <sup>3</sup>	about x-x mm	about y-y mm
EH7663	6061 T6	15.08	5586	927	53900000	43000000	302979	356373	98.23	87.74

**Note:** The structural section properties are given for the complete mast

## Post Covers

HALF SIZE SECTIONS

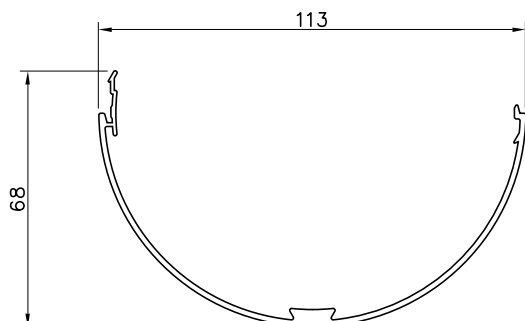

EP3705  
SELF MATING POST COVER

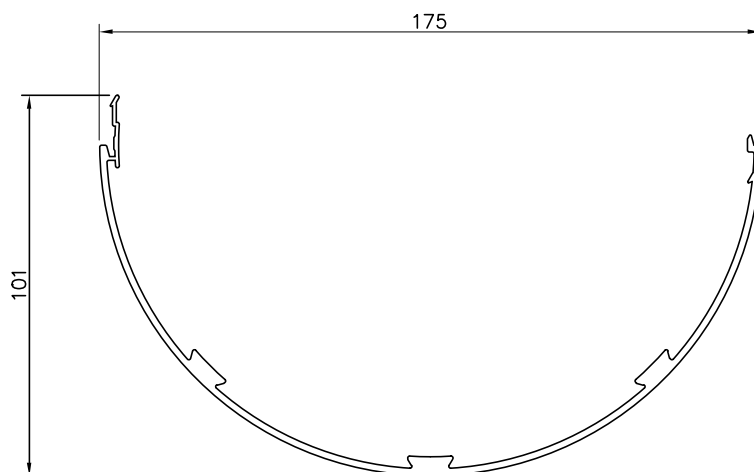

EP3706  
SELF MATING POST COVER

Extrusion No.	Alloy/ Temper	Mass per metre kg/m	Area of Section mm <sup>2</sup>	Anodising Perimeter mm	Moment of Inertia (I)		Section Modulus (Z)		Radius of Gyration (k)	
					about x-x mm <sup>4</sup>	about y-y mm <sup>4</sup>	about x-x mm <sup>3</sup>	about y-y mm <sup>3</sup>	about x-x mm	about y-y mm
EP3705	6060 T5	0.874	323	407	125730	485310	2775	8219	19.73	38.76
EP3706	6106 T5	1.692	636	624	483700	2306670	7172	25715	27.80	60.70

# Thresholds

FULL SIZE SECTIONS

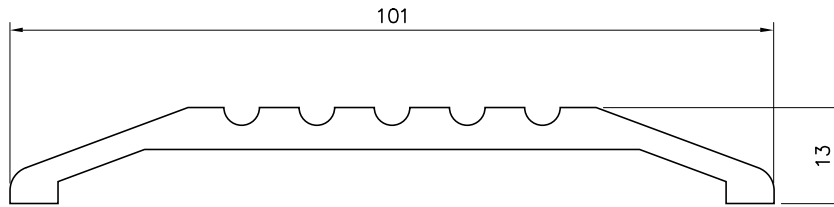

E01854  
THRESHOLD

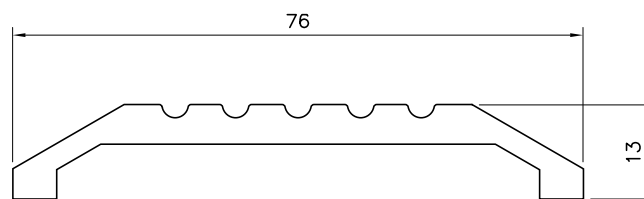

E01853  
THRESHOLD

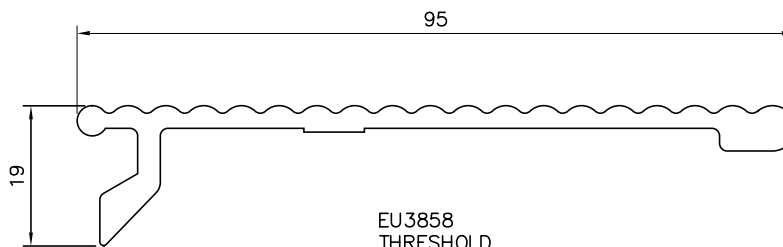

EU3858  
THRESHOLD

Extrusion No.	Alloy/ Temper	Mass per metre kg/m	Area of Section mm <sup>2</sup>	Anodising Perimeter mm	Moment of Inertia (I)		Section Modulus (Z)		Radius of Gyration (k)	
					about x-x mm <sup>4</sup>	about y-y mm <sup>4</sup>	about x-x mm <sup>3</sup>	about y-y mm <sup>3</sup>	about x-x mm	about y-y mm
E01854	6061 T6	1.218	450	233	3810	371050	470	7304	2.91	28.72
E01853	6060 T5	1.020	377	183	3550	183310	438	4811	3.07	22.05
EU3858	6060 T5	0.914	338	241	5030	329250	336	6377	3.86	31.21

## Coamings

### FULL SIZE SECTIONS

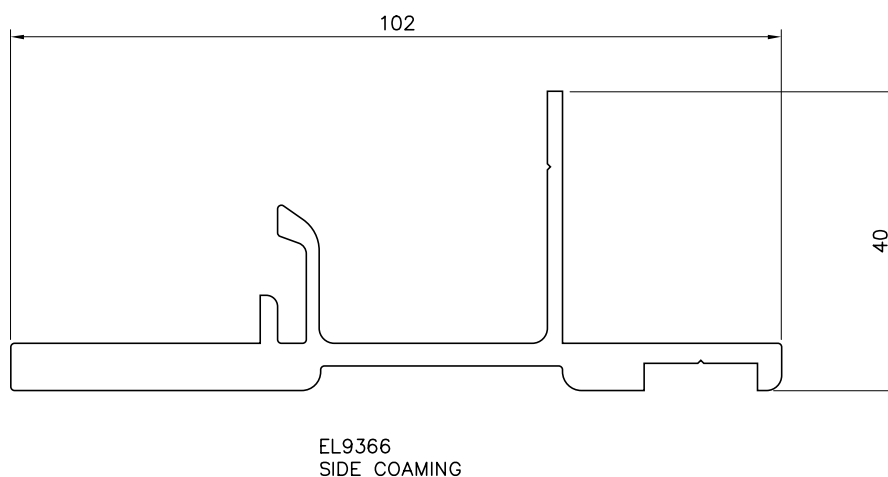
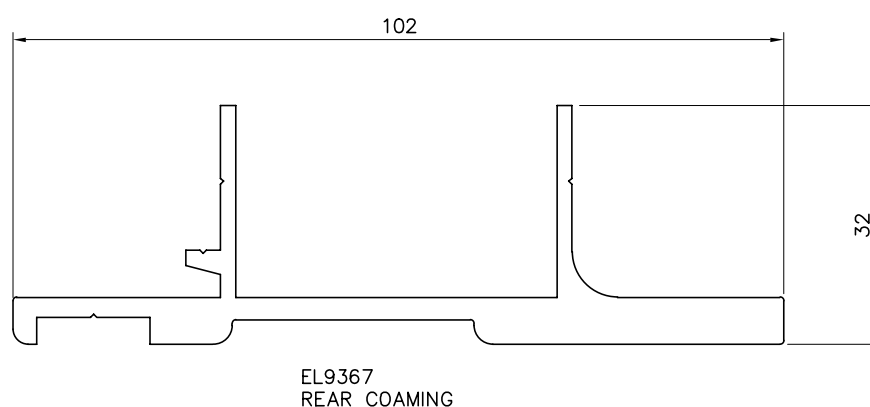
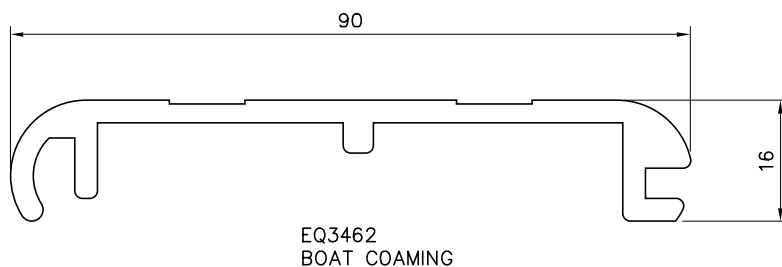

Extrusion No.	Alloy/ Temper	Mass per metre kg/m	Area of Section mm <sup>2</sup>	Anodising Perimeter mm	Moment of Inertia (I)		Section Modulus (Z)		Radius of Gyration (k)	
					about x-x mm <sup>4</sup>	about y-y mm <sup>4</sup>	about x-x mm <sup>3</sup>	about y-y mm <sup>3</sup>	about x-x mm	about y-y mm
EQ3462	6060 T591	1.096	405	259	7280	376310	635	8200	4.24	30.48
EL9367	6106 T6	1.610	596	334	26680	497760	1060	8959	6.69	28.90
EL9366	6106 T6	1.615	598	343	34770	479520	1059	8776	7.63	28.32

## Door Stile / Frames

FULL SIZE SECTIONS

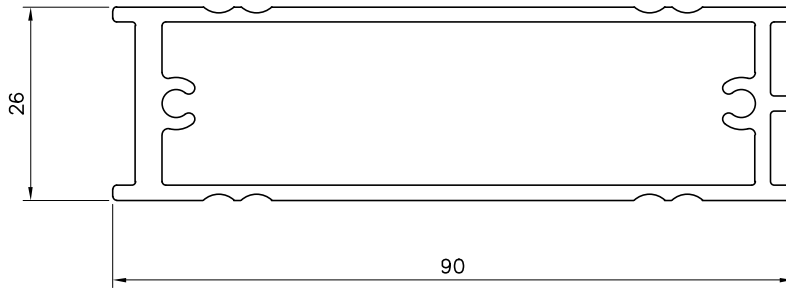

EA2214  
DOOR STILE

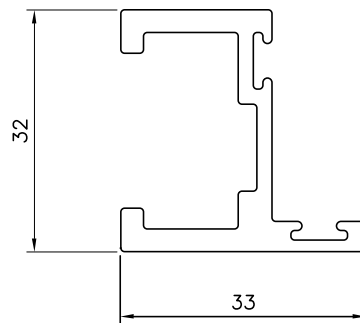

EA2215  
DOOR FRAME

Extrusion No.	Alloy/ Temper	Mass per metre kg/m	Area of Section mm <sup>2</sup>	Anodising Perimeter mm	Moment of Inertia (I)		Section Modulus (Z)		Radius of Gyration (k)	
					about x-x mm <sup>4</sup>	about y-y mm <sup>4</sup>	about x-x mm <sup>3</sup>	about y-y mm <sup>3</sup>	about x-x mm	about y-y mm
EA2214	6060 T5	1.342	497	249	52250	475000	4082	10109	10.25	30.91
EA2215	6060 T5	0.659	243	189	38080	15540	2075	846	12.52	8.00

## Bulbs

### FULL SIZE SECTIONS

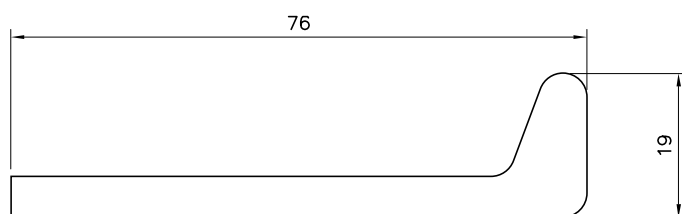

EH9987  
FLAT BULB

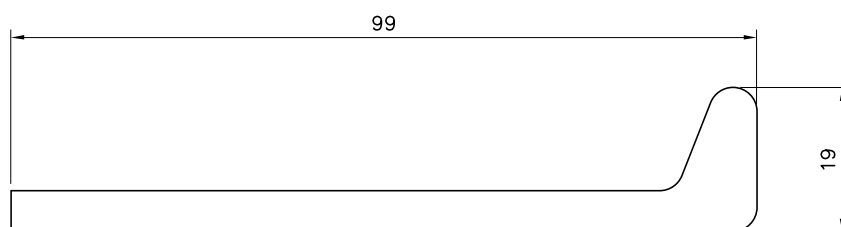

EL6940  
FLAT BULB

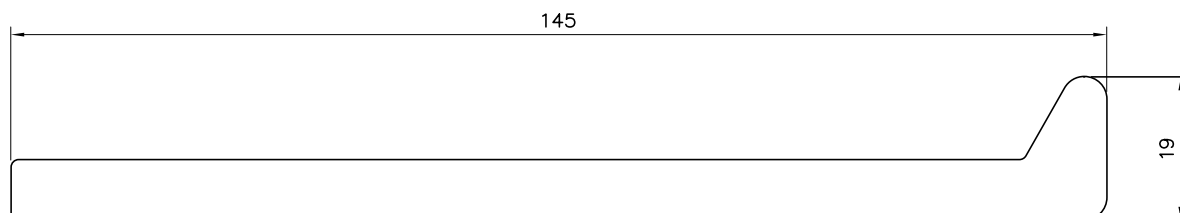

E25398  
FLAT BULB

Extrusion No.	Alloy/ Temper	Mass per metre kg/m	Area of Section mm <sup>2</sup>	Anodising Perimeter mm	Moment of Inertia (I)		Section Modulus (Z)		Radius of Gyration (k)	
					about x-x mm <sup>4</sup>	about y-y mm <sup>4</sup>	about x-x mm <sup>3</sup>	about y-y mm <sup>3</sup>	about x-x mm	about y-y mm
EH9987	6351 T6	1.392	515	182	8670	294590	595	6545	4.10	23.92
EL6940	6061 T6	1.719	636	227	9280	609920	622	10736	3.82	30.96
E25398	6061 T6	3.353	1242	320	12720	2387760	883	30994	3.20	43.85

## Bulbs (cont)

FULL SIZE SECTIONS

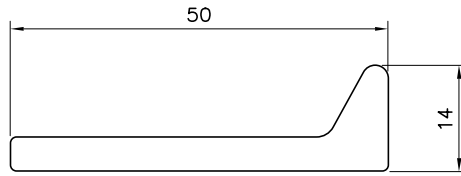

EL9067  
FLAT BULB

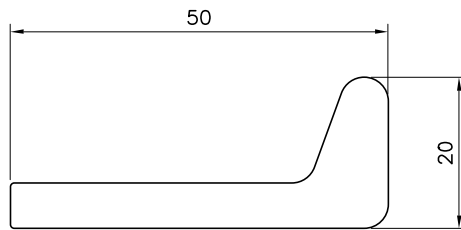

E33377  
FLAT BULB

Extrusion No.	Alloy/ Temper	Mass per metre kg/m	Area of Section mm <sup>2</sup>	Anodising Perimeter mm	Moment of Inertia (I)		Section Modulus (Z)		Radius of Gyration (k)	
					about x-x mm <sup>4</sup>	about y-y mm <sup>4</sup>	about x-x mm <sup>3</sup>	about y-y mm <sup>3</sup>	about x-x mm	about y-y mm
EL9067	6061 T6	0.732	271	122	2180	65940	204	2286	2.84	15.60
E33377	6061 T6	1.100	407	131	8990	96940	617	3183	4.70	15.43

## Bulbs (cont)

FULL SIZE SECTIONS

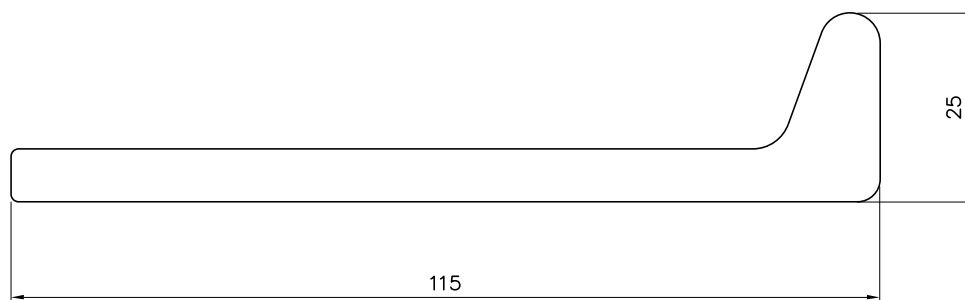

EP4178  
FLAT BULB

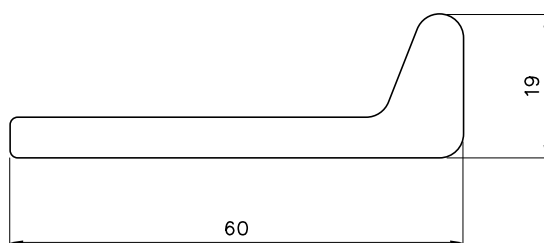

EP4481  
FLAT BULB

Extrusion No.	Alloy/ Temper	Mass per metre kg/m	Area of Section mm <sup>2</sup>	Anodising Perimeter mm	Moment of Inertia (I)		Section Modulus (Z)		Radius of Gyration (k)	
					about x-x mm <sup>4</sup>	about y-y mm <sup>4</sup>	about x-x mm <sup>3</sup>	about y-y mm <sup>3</sup>	about x-x mm	about y-y mm
EP4178	6082 T6	2.650	981	269	25940	1279890	1333	19131	5.14	36.12
EP4481	6082 T6	1.155	427	149	8120	149260	571	4106	4.36	18.70

## Step Treads / Running Boards

HALF SIZE SECTIONS

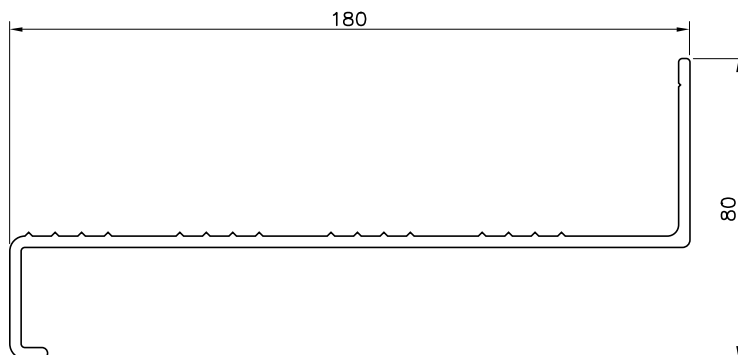

E25545  
STEP TREAD

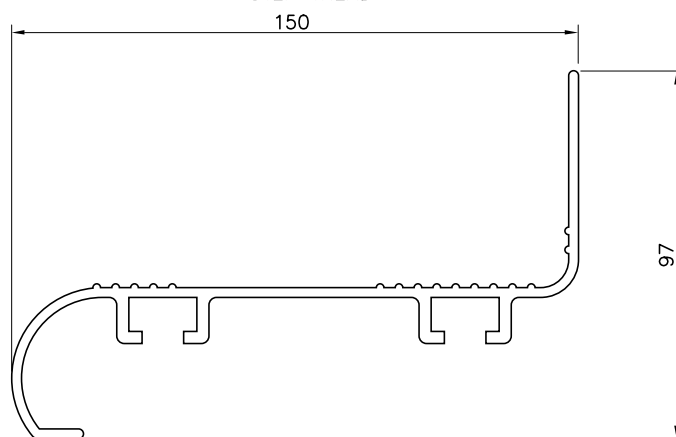

E36174  
RUNNING BOARD

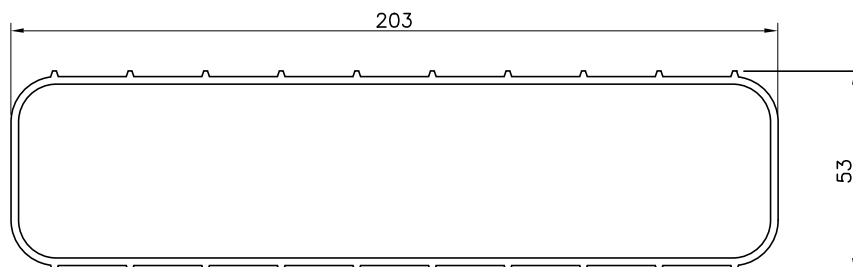

E25067  
STEP TREAD

Extrusion No.	Alloy/ Temper	Mass per metre kg/m	Area of Section mm <sup>2</sup>	Anodising Perimeter mm	Moment of Inertia (I)		Section Modulus (Z)		Radius of Gyration (k)	
					about x-x mm <sup>4</sup>	about y-y mm <sup>4</sup>	about x-x mm <sup>3</sup>	about y-y mm <sup>3</sup>	about x-x mm	about y-y mm
E25545	6061 T6	2.159	799	538	154230	3369260	3316	35775	13.89	64.94
E36174	6060 T5	2.317	858	627	283520	2351160	4800	29240	18.18	52.35
E25067	6060 T5	2.709	1003	528	505320	4401780	20213	43367	22.45	66.25

## Step Treads (cont)

FULL SIZE SECTIONS

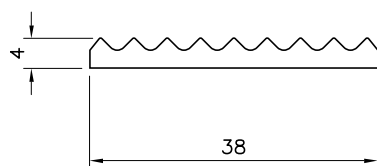

E2782  
TREAD

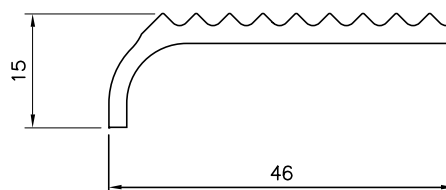

E2611  
BULL NOSE STAIR TREAD

Extrusion No.	Alloy/ Temper	Mass per metre kg/m	Area of Section mm <sup>2</sup>	Anodising Perimeter mm	Moment of Inertia (I)		Section Modulus (Z)		Radius of Gyration (k)	
					about x-x mm <sup>4</sup>	about y-y mm <sup>4</sup>	about x-x mm <sup>3</sup>	about y-y mm <sup>3</sup>	about x-x mm	about y-y mm
E2782	6060 T5	0.313	115	92	110	14160	46	743	0.98	11.10
E2611	6060 T1	0.420	155	122	1490	30340	131	1196	3.10	13.99

## Side Steps / Punts

HALF SIZE SECTIONS

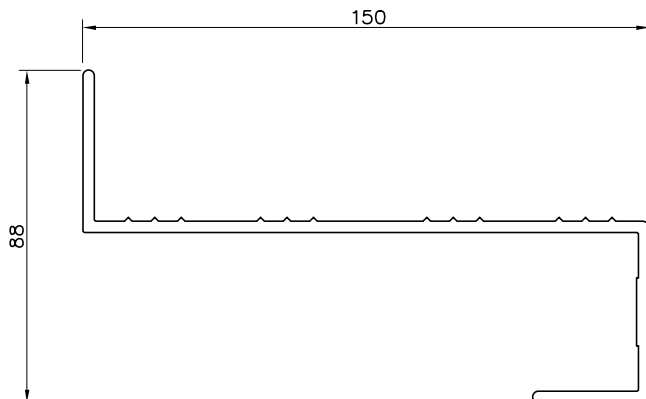

EN2468  
SIDE STEP

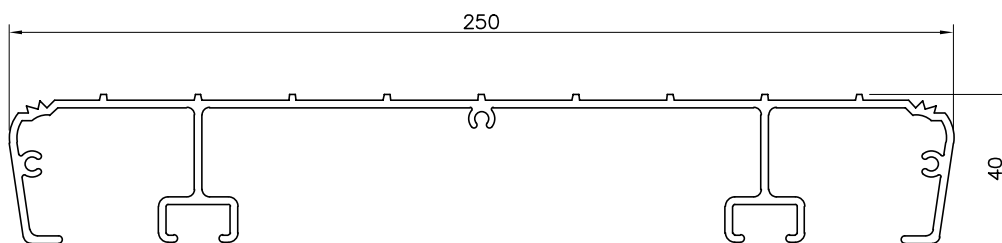

E25493  
SIDE STEP

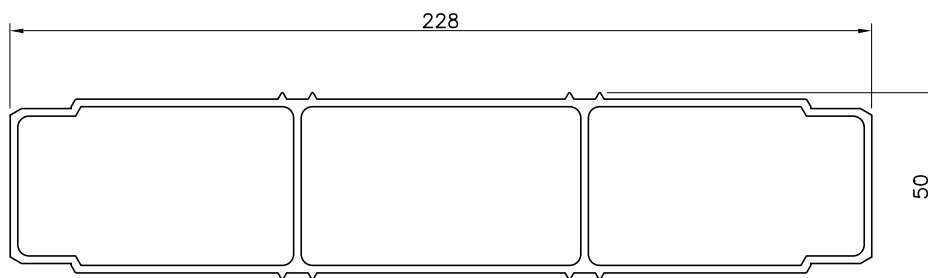

EL9436  
MARINE OYSTER PUNT

Extrusion No.	Alloy/ Temper	Mass per metre kg/m	Area of Section mm <sup>2</sup>	Anodising Perimeter mm	Moment of Inertia (I)		Section Modulus (Z)		Radius of Gyration (k)	
					about x-x mm <sup>4</sup>	about y-y mm <sup>4</sup>	about x-x mm <sup>3</sup>	about y-y mm <sup>3</sup>	about x-x mm	about y-y mm
EN2468	6063 T594	2.161	800	538	314240	2482700	6679	30053	19.82	55.71
E25493	6106 T6	2.796	1035	1014	177270	7363130	6763	58905	13.09	84.35
EL9436	6060 T5	3.437	1273	555	489770	6226460	19591	54618	19.61	69.94

## Stock Crates

## FULL SIZE SECTIONS

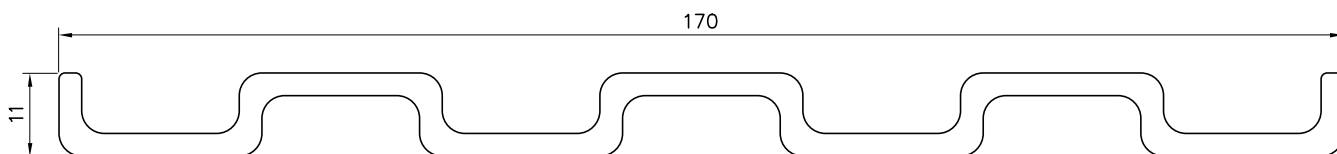
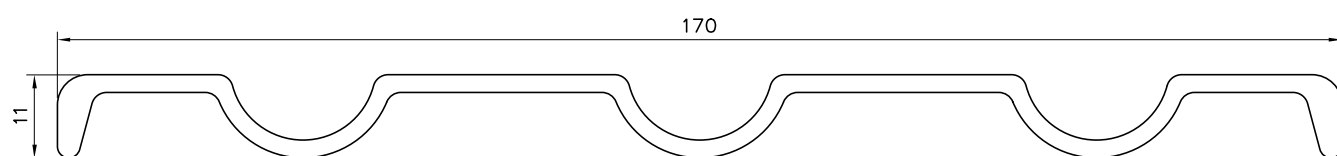
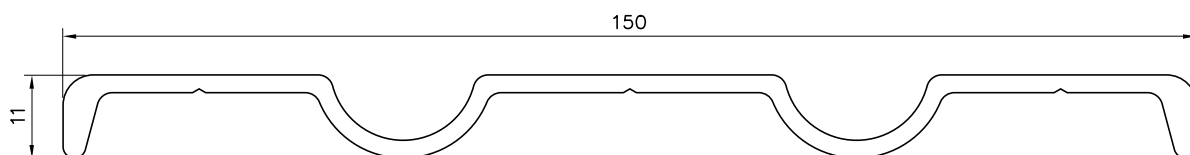
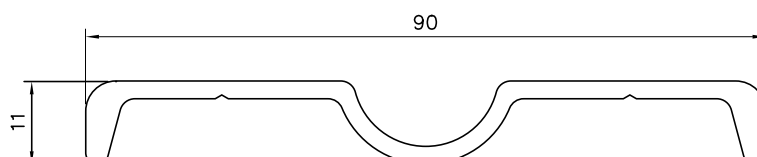
 EN9602  
STOCK CRATES

 EN4046  
STOCK CRATES

 EN3828  
STOCK CRATES

 EN3827  
STOCK CRATES

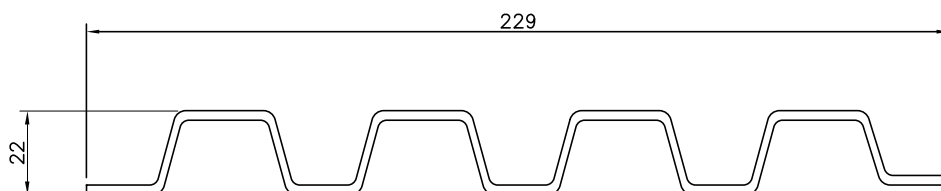
Extrusion No.	Alloy/ Temper	Mass per metre kg/m	Area of Section mm <sup>2</sup>	Anodising Perimeter mm	Moment of Inertia (I)		Section Modulus (Z)		Radius of Gyration (k)	
					about x-x mm <sup>4</sup>	about y-y mm <sup>4</sup>	about x-x mm <sup>3</sup>	about y-y mm <sup>3</sup>	about x-x mm	about y-y mm
EN9602	6106 T6	1.894	701	437	9360	1796510	1603	21135	3.65	50.62
EN4046	6106 T6	1.395	516	414	5850	1475870	843	17363	3.37	53.48
EN3828	6106 T6	1.211	448	360	4760	1006790	646	13424	3.26	47.41
EN3827	6106 T6	0.779	288	224	2970	251140	404	5581	3.21	29.53

## Headboards / Spray Rails

HALF SIZE SECTIONS



EG2739  
HEADBOARD

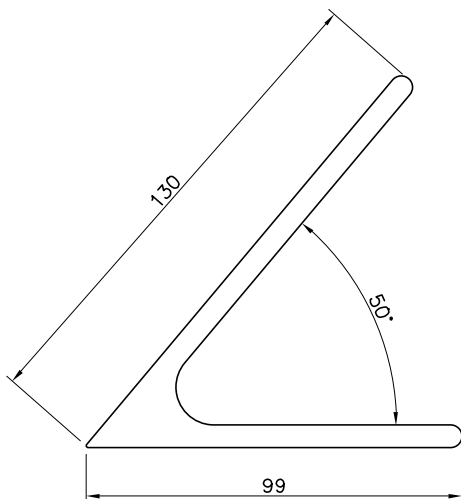

E36974  
MARINE SPRAY RAIL

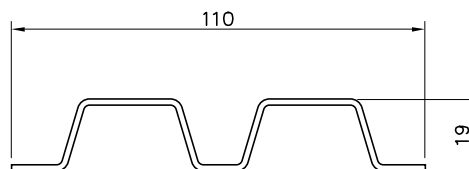

E4099  
HEADBOARD

Extrusion No.	Alloy/ Temper	Mass per metre kg/m	Area of Section mm <sup>2</sup>	Anodising Perimeter mm	Moment of Inertia (I)		Section Modulus (Z)		Radius of Gyration (k)	
					about x-x mm <sup>4</sup>	about y-y mm <sup>4</sup>	about x-x mm <sup>3</sup>	about y-y mm <sup>3</sup>	about x-x mm	about y-y mm
EG2739	6061 T6	2.133	790	679	53310	3267950	4632	28506	8.21	64.32
E36974	6082 T6	3.767	1395	419	1291000	879000	18448	16557	30.42	25.10
E4099	6061 T6	0.693	257	318	13390	240580	1321	4385	7.22	30.60

## Pontoon Stringers

HALF SIZE SECTIONS

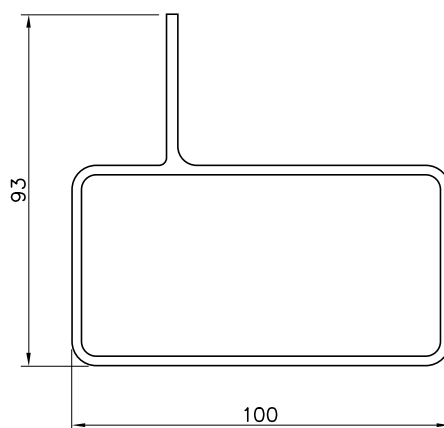

E36376  
PONTOON STRINGER

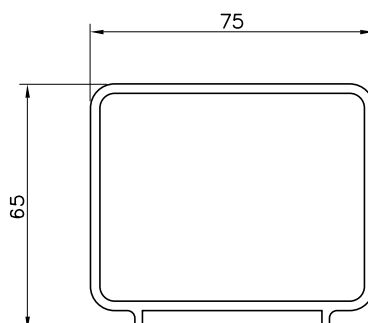

E36378  
PONTOON STRINGER

Extrusion No.	Alloy/ Temper	Mass per metre kg/m	Area of Section mm <sup>2</sup>	Anodising Perimeter mm	Moment of Inertia (I)		Section Modulus (Z)		Radius of Gyration (k)	
					about x-x mm <sup>4</sup>	about y-y mm <sup>4</sup>	about x-x mm <sup>3</sup>	about y-y mm <sup>3</sup>	about x-x mm	about y-y mm
E36376	6082 T5	2.279	844	651	591000	991000	9901	18523	26.46	34.27
E36378	6082 T5	1.764	653	275	385400	525380	11419	14010	24.29	28.36

## Sail Tracks and Drip Moulds

### FULL SIZE SECTIONS

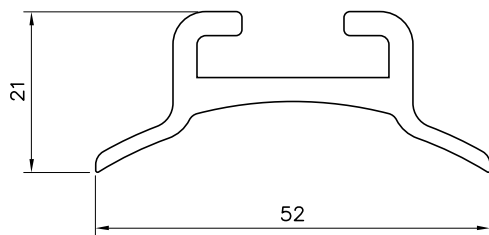

EH3879  
SAIL TRACK

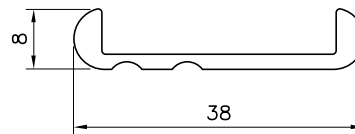

EA1963  
INTERIOR TRIM

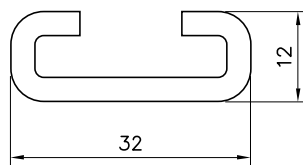

E4200  
SAIL TRACK

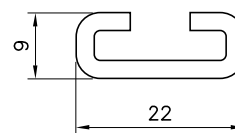

E4204  
SAIL TRACK

Extrusion No.	Alloy/ Temper	Mass per metre kg/m	Area of Section mm <sup>2</sup>	Anodising Perimeter mm	Moment of Inertia (I)		Section Modulus (Z)		Radius of Gyration (k)	
					about x-x mm <sup>4</sup>	about y-y mm <sup>4</sup>	about x-x mm <sup>3</sup>	about y-y mm <sup>3</sup>	about x-x mm	about y-y mm
EH3879	6061 T6	0.718	266	178	7360	48010	627	1839	5.26	13.43
EA1963	6060 T5	0.276	102	98	420	17860	75	909	2.03	13.23
E4200	6061 T6	0.484	179	119	2640	20080	378	1265	3.84	10.59
E4204	6061 T6	0.264	98	87	783	5219	158	469	2.83	7.30

## Sail Tracks and Drip Moulds (cont)

FULL SIZE SECTIONS

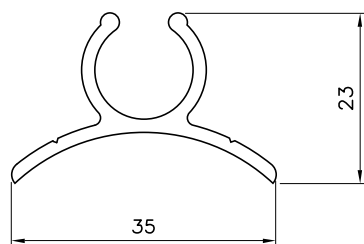
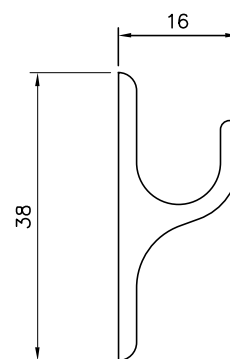
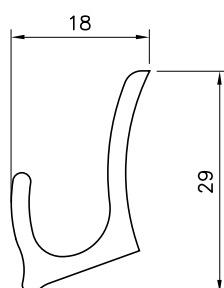
 EL1423  
SAIL TRACK

 EG6452  
DRIP MOULD

 E3311  
DRIP MOULD

Extrusion No.	Alloy/ Temper	Mass per metre kg/m	Area of Section mm <sup>2</sup>	Anodising Perimeter mm	Moment of Inertia (I)		Section Modulus (Z)		Radius of Gyration (k)	
					about x-x mm <sup>4</sup>	about y-y mm <sup>4</sup>	about x-x mm <sup>3</sup>	about y-y mm <sup>3</sup>	about x-x mm	about y-y mm
EL1423	6061 T6	0.347	128	141	4490	9430	358	539	5.92	8.58
EG6452	1200 F	0.438	162	115	11770	4070	584	364	8.52	5.01
E3311	6060 T5	0.355	131	102	7820	4250	429	441	7.73	5.70

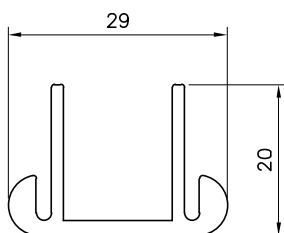
# Partitions

## FULL SIZE SECTIONS



E73467  
INTERNAL PARTITION CORNER SECTION

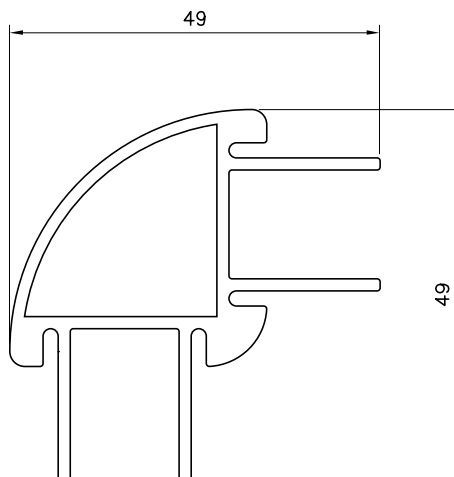

E73468  
INTERNAL PARTITION CORNER SECTION

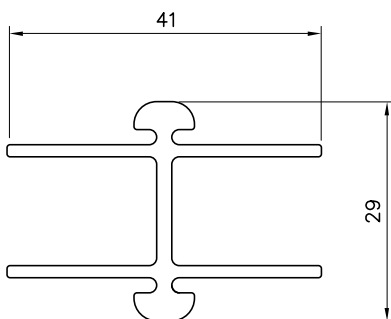

E73469  
INTERNAL PARTITION CORNER SECTION

Extrusion No.	Alloy/ Temper	Mass per metre kg/m	Area of Section mm <sup>2</sup>	Anodising Perimeter mm	Moment of Inertia (I)		Section Modulus (Z)		Radius of Gyration (k)	
					about x-x mm <sup>4</sup>	about y-y mm <sup>4</sup>	about x-x mm <sup>3</sup>	about y-y mm <sup>3</sup>	about x-x mm	about y-y mm
E73467	6060 T5	0.381	141	149	4000	12000	286	828	5.33	9.23
E73468	6060 T5	0.988	365	290	59040	59040	2189	2189	12.72	12.72
E73469	6060 T5	0.604	223	232	18050	19320	1245	929	9.00	9.31

## Partitions (cont)

FULL SIZE SECTIONS

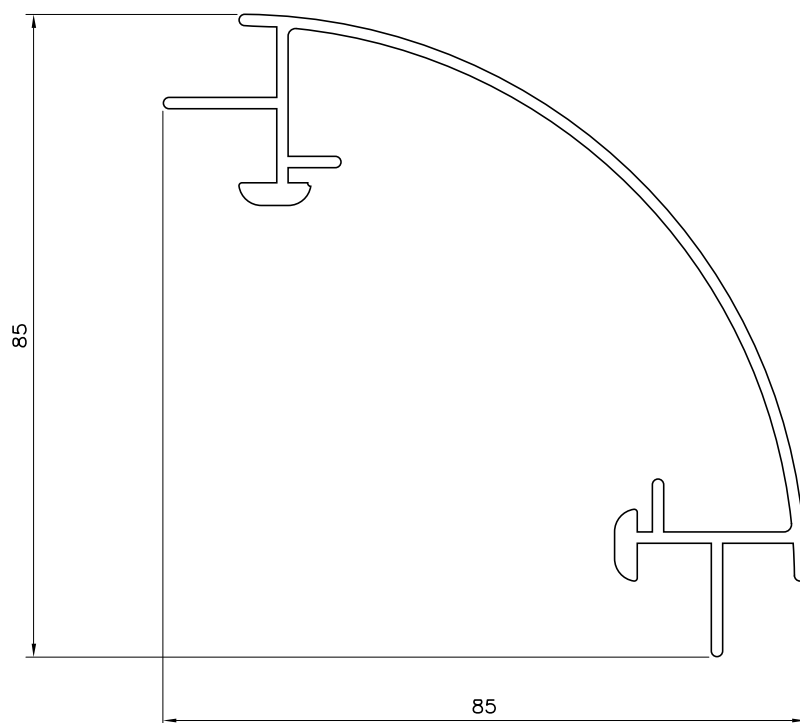
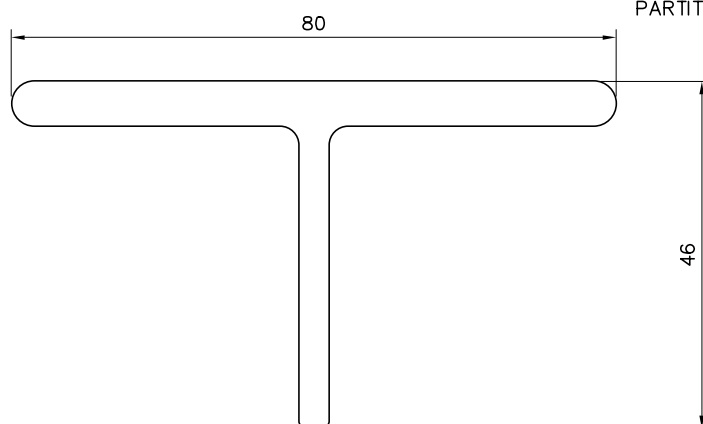
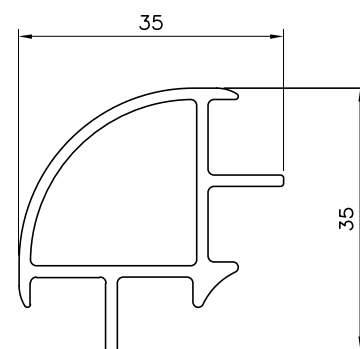
 EA1115  
PARTITION

 EU9871  
WINDOW TEE

 EA2853  
PARTITION

Extrusion No.	Alloy/ Temper	Mass per metre kg/m	Area of Section mm <sup>2</sup>	Anodising Perimeter mm	Moment of Inertia (I)		Section Modulus (Z)		Radius of Gyration (k)	
					about x-x mm <sup>4</sup>	about y-y mm <sup>4</sup>	about x-x mm <sup>3</sup>	about y-y mm <sup>3</sup>	about x-x mm	about y-y mm
EA1115	6060 T5	0.948	351	439	252330	252330	5117	5117	26.81	26.81
EU9871	6082 T5	1.713	634	243	85380	244280	2295	6107	11.60	19.63
EA2853	6060 T5	0.500	185	153	16860	16860	770	770	9.55	9.55

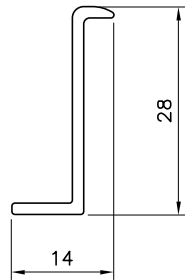
## Partitions (cont)

FULL SIZE SECTIONS



EA2854  
CABINET DOOR JAMB

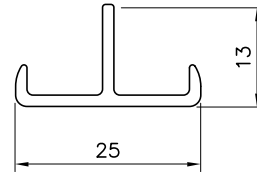

EA2855  
END CAP

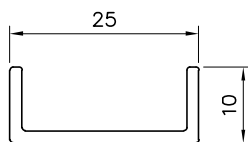

EA2857  
SUPPORT CHANNEL

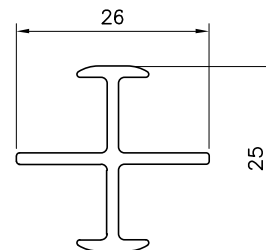

EA2856  
JOINER

Extrusion No.	Alloy/ Temper	Mass per metre kg/m	Area of Section mm <sup>2</sup>	Anodising Perimeter mm	Moment of Inertia (I)		Section Modulus (Z)		Radius of Gyration (k)	
					about x-x mm <sup>4</sup>	about y-y mm <sup>4</sup>	about x-x mm <sup>3</sup>	about y-y mm <sup>3</sup>	about x-x mm	about y-y mm
EA2854	6060 T5	0.157	58	79	5260	340	342	42	9.52	2.42
EA2855	6060 T5	0.174	65	87	770	3083	63	144	3.44	6.89
EA2857	6060 T5	0.180	66	85	560	5750	78	460	2.91	9.33
EA2856	6060 T5	0.255	94	125	460	2210	36	167	2.21	4.85

## Channels

### HALF SIZE SECTIONS

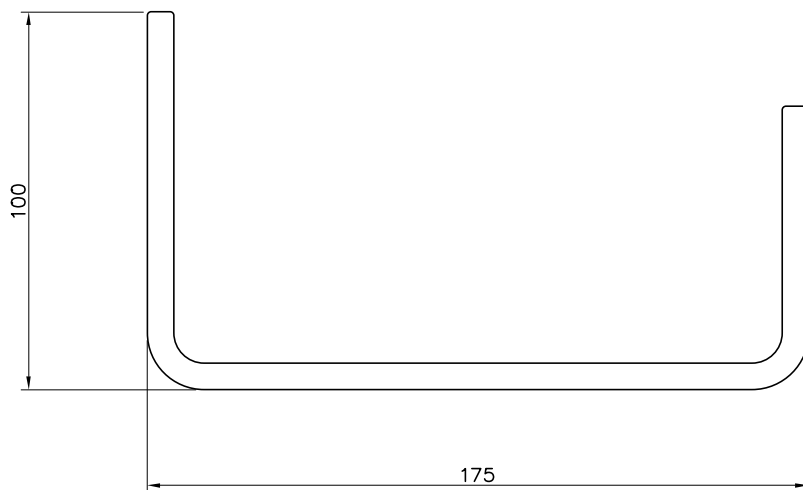

E25360  
CHANNEL

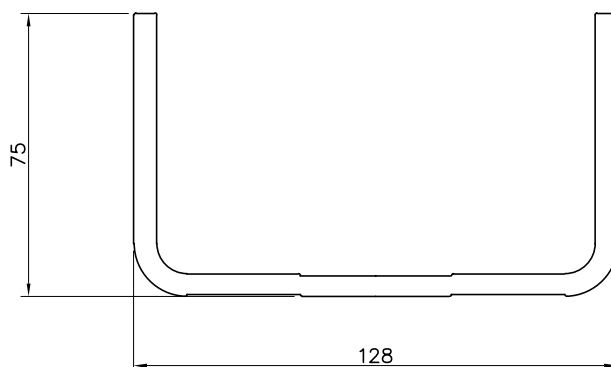

E35781  
CHANNEL

Extrusion No.	Alloy/ Temper	Mass per metre kg/m	Area of Section mm <sup>2</sup>	Anodising Perimeter mm	Moment of Inertia (I)		Section Modulus (Z)		Radius of Gyration (k)	
					about x-x mm <sup>4</sup>	about y-y mm <sup>4</sup>	about x-x mm <sup>3</sup>	about y-y mm <sup>3</sup>	about x-x mm	about y-y mm
E25360	6061 T6	6.162	2282	664	1831420	10467920	24622	119633	28.33	67.73
E35781	6106 T6	4.020	1488	525	840670	3863770	16468	60371	23.77	50.96

## Channels (cont)

### HALF SIZE SECTIONS



EQ1364  
CHANNEL

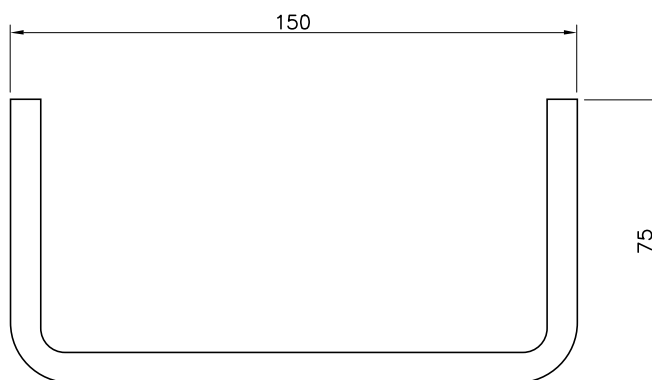

EL9130  
CHANNEL

Extrusion No.	Alloy/ Temper	Mass per metre kg/m	Area of Section mm <sup>2</sup>	Anodising Perimeter mm	Moment of Inertia (I)		Section Modulus (Z)		Radius of Gyration (k)	
					about x-x mm <sup>4</sup>	about y-y mm <sup>4</sup>	about x-x mm <sup>3</sup>	about y-y mm <sup>3</sup>	about x-x mm	about y-y mm
EQ1364	6061 T6 6060 T5	3.947	1482	533	832700	3850460	16392	60163	23.70	50.97
EL9130	6061 T6	5.889	2181	564	1168210	7180400	22252	95739	23.14	57.38

## Channels (cont)

HALF SIZE SECTIONS

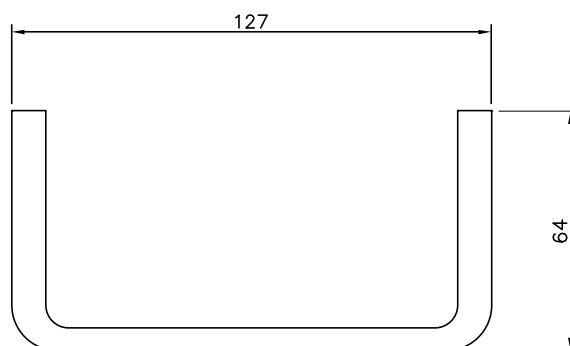

EQ2556  
BULLBAR

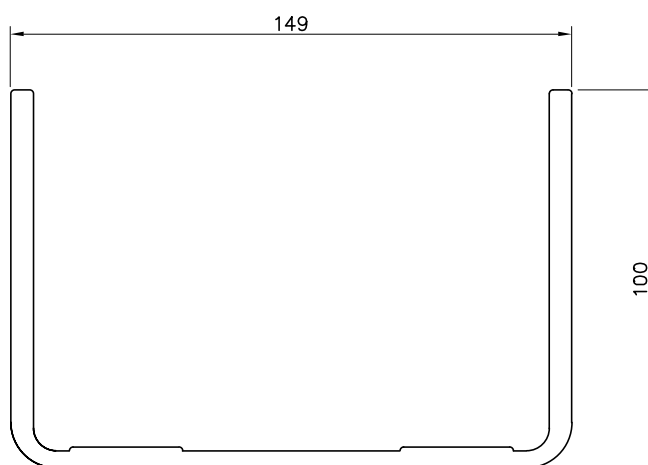

EQ1510  
BULLBAR

Extrusion No.	Alloy/ Temper	Mass per metre kg/m	Area of Section mm <sup>2</sup>	Anodising Perimeter mm	Moment of Inertia (I)		Section Modulus (Z)		Radius of Gyration (k)	
					about x-x mm <sup>4</sup>	about y-y mm <sup>4</sup>	about x-x mm <sup>3</sup>	about y-y mm <sup>3</sup>	about x-x mm	about y-y mm
EQ2556	6106 T6	4.727	1751	481	710700	4448800	17051	70060	20.15	50.41
EQ1510	6351 T5	4.850	1796	675	1890530	6854990	28749	92323	32.44	61.78

# Roperail Bracket

FULL SIZE SECTIONS

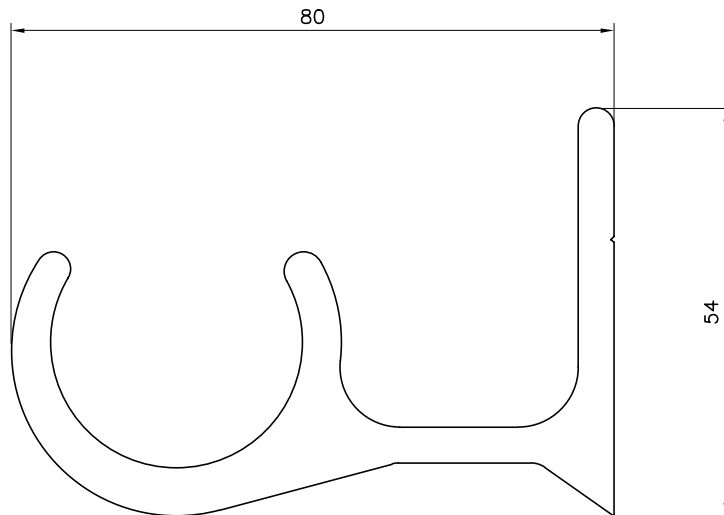

EK8779  
ROPERAIL BRACKET

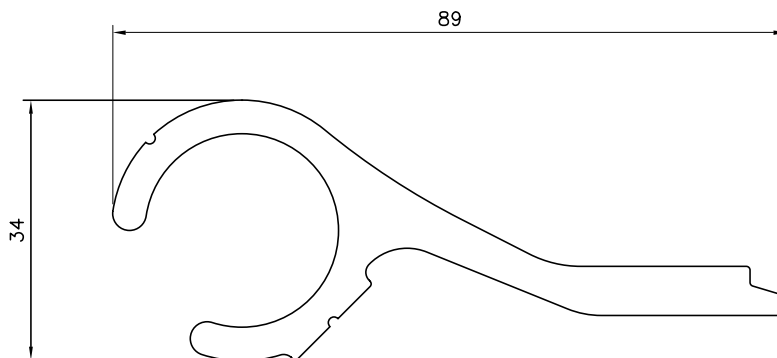

EL7667  
ROPERAIL BRACKET

Extrusion No.	Alloy/ Temper	Mass per metre kg/m	Area of Section mm <sup>2</sup>	Anodising Perimeter mm	Moment of Inertia (I)		Section Modulus (Z)		Radius of Gyration (k)	
					about x-x mm <sup>4</sup>	about y-y mm <sup>4</sup>	about x-x mm <sup>3</sup>	about y-y mm <sup>3</sup>	about x-x mm	about y-y mm
EK8779	6061 T6	2.625	972	339	148640	682130	3964	15367	12.37	26.49
EL7667	6106 T6	1.897	702	272	57390	393360	3053	7926	9.04	23.67

## Table Edge

FULL SIZE SECTIONS

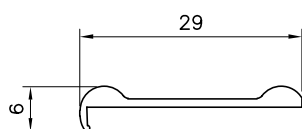
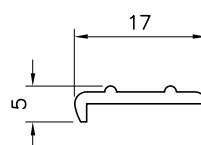
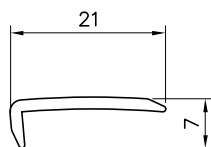
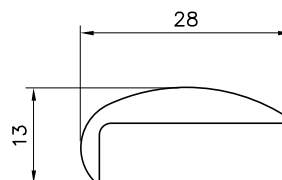
 EG2500  
TABLE EDGE

 EG1111  
TABLE EDGE

 EH2351  
TABLE EDGE

 E3388  
TABLE EDGE

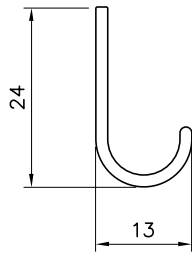
Extrusion No.	Alloy/ Temper	Mass per metre kg/m	Area of Section mm <sup>2</sup>	Anodising Perimeter mm	Moment of Inertia (I)		Section Modulus (Z)		Radius of Gyration (k)	
					about x-x mm <sup>4</sup>	about y-y mm <sup>4</sup>	about x-x mm <sup>3</sup>	about y-y mm <sup>3</sup>	about x-x mm	about y-y mm
EG2500	6060 T5	0.131	48	68	40	4640	10	302	0.91	9.83
EG1111	1200 H112	0.084	31	42	20	820	7	86	0.80	5.14
EH2351	6060 T1	0.100	37	51	70	1430	13	119	1.38	6.22
E3388	6106 T6	0.292	108	71	620	5980	69	456	2.40	7.44

# Trim

## FULL SIZE SECTIONS



EG6454  
J-TRIM

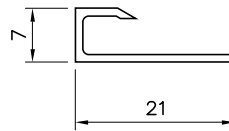

EH1553  
WALLBOARD EDGE

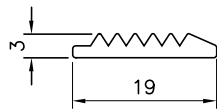

E4025  
TRANSPORT TRIM

Extrusion No.	Alloy/ Temper	Mass per metre kg/m	Area of Section mm <sup>2</sup>	Anodising Perimeter mm	Moment of Inertia (I)		Section Modulus (Z)		Radius of Gyration (k)	
					about x-x mm <sup>4</sup>	about y-y mm <sup>4</sup>	about x-x mm <sup>3</sup>	about y-y mm <sup>3</sup>	about x-x mm	about y-y mm
EG6454	6060 F	0.154	57	75	2850	1010	191	115	7.07	4.21
EH1553	1200 H112	0.090	33	69	220	1370	46	100	2.58	6.44
E4025	1200 F	0.120	44	50	30	1220	15	124	0.83	5.27

## Trim (cont)

HALF SIZE SECTIONS

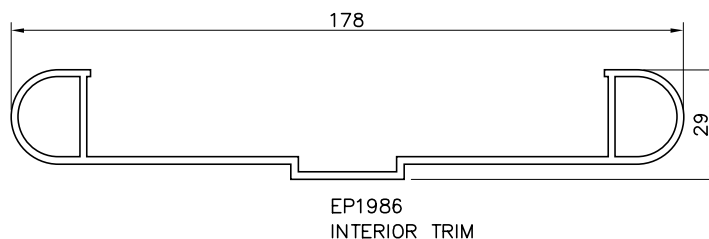
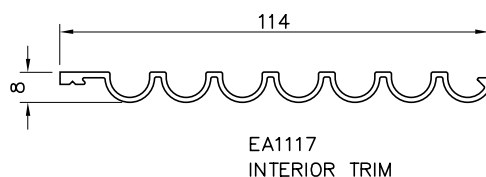

Extrusion No.	Alloy/ Temper	Mass per metre kg/m	Area of Section mm <sup>2</sup>	Anodising Perimeter mm	Moment of Inertia (I)		Section Modulus (Z)		Radius of Gyration (k)	
					about x-x mm <sup>4</sup>	about y-y mm <sup>4</sup>	about x-x mm <sup>3</sup>	about y-y mm <sup>3</sup>	about x-x mm	about y-y mm
EA1117	6463 T5	0.641	237	346	1470	270440	368	4722	2.49	33.78
EP1986	6060 T5	1.519	562	450	42200	2074010	2226	23303	8.67	60.75

## Windscreen / Canopy

FULL SIZE SECTIONS

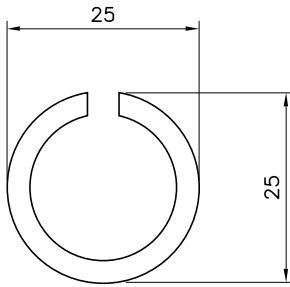

EQ4010  
WINDSCREEN SURROUND

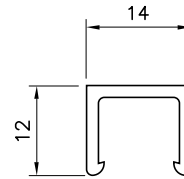

EG8490  
CANOPY GLAZING CHANNEL

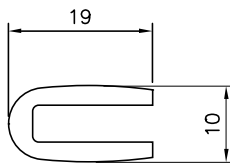

EH1600  
WINDSCREEN

Extrusion No.	Alloy/ Temper	Mass per metre kg/m	Area of Section mm <sup>2</sup>	Anodising Perimeter mm	Moment of Inertia (I)		Section Modulus (Z)		Radius of Gyration (k)	
					about x-x mm <sup>4</sup>	about y-y mm <sup>4</sup>	about x-x mm <sup>3</sup>	about y-y mm <sup>3</sup>	about x-x mm	about y-y mm
EQ4010	6060 T591	0.536	198	138	11810	13460	881	1060	7.72	8.24
EG8490	6060 H112	0.150	55	72	790	1600	106	230	3.79	5.39
EH1600	6060 T591	0.266	98	84	1170	2940	262	268	3.46	5.48

## Seating

HALF SIZE SECTIONS

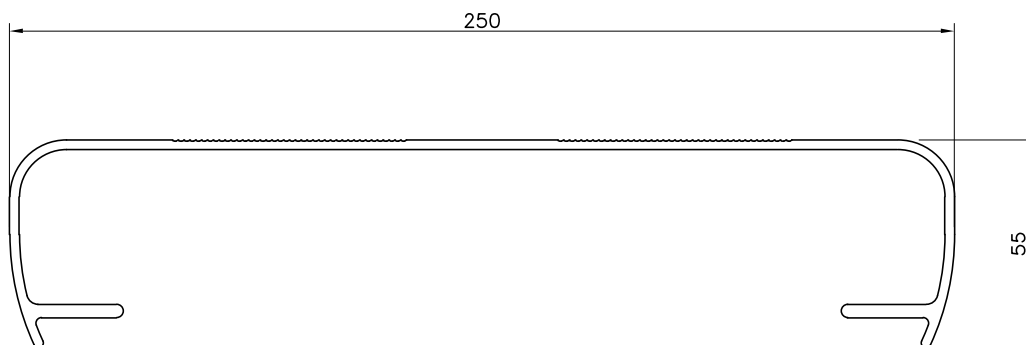

EL2327  
SPECTATOR SEAT

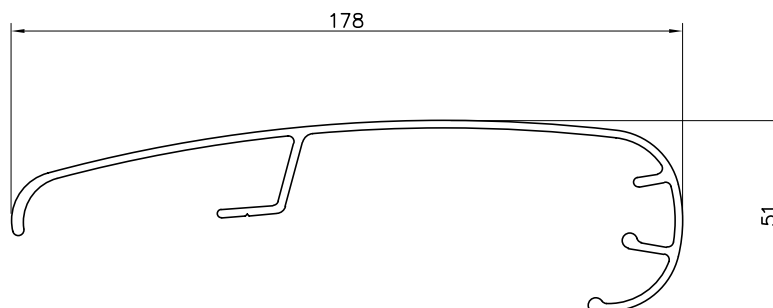

EL2962  
SEATING BACK REST

Extrusion No.	Alloy/ Temper	Mass per metre kg/m	Area of Section mm <sup>2</sup>	Anodising Perimeter mm	Moment of Inertia (I)		Section Modulus (Z)		Radius of Gyration (k)	
					about x-x mm <sup>4</sup>	about y-y mm <sup>4</sup>	about x-x mm <sup>3</sup>	about y-y mm <sup>3</sup>	about x-x mm	about y-y mm
EL2327	6060 T5	2.776	1028	796	379300	8838330	9726	70707	19.21	92.72
EL2962	6060 T5	1.737	643	598	128280	2204870	3600	21542	14.12	58.56

## Seating (cont)

FULL SIZE SECTIONS

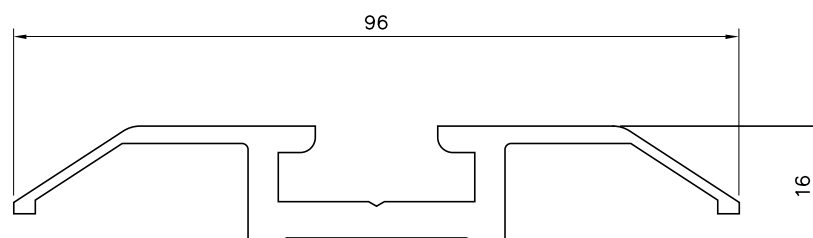

EU7671  
SEAT BRACKET

Extrusion No.	Alloy/ Temper	Mass per metre kg/m	Area of Section mm <sup>2</sup>	Anodising Perimeter mm	Moment of Inertia (I)		Section Modulus (Z)		Radius of Gyration (k)	
					about x-x mm <sup>4</sup>	about y-y mm <sup>4</sup>	about x-x mm <sup>3</sup>	about y-y mm <sup>3</sup>	about x-x mm	about y-y mm
EU7671	6351 T5	1.108	410	274	10620	174880	1264	3643	5.09	20.65

## Belting

HALF SIZE SECTIONS

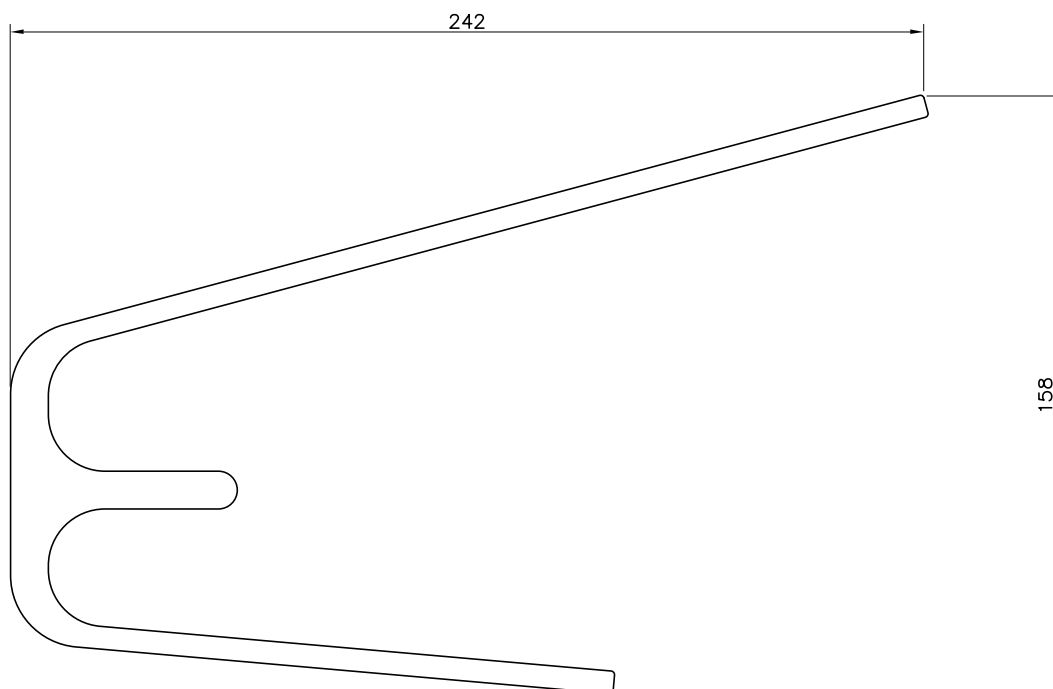

E26674  
BELTING / FENDER

Extrusion No.	Alloy/ Temper	Mass per metre kg/m	Area of Section mm <sup>2</sup>	Anodising Perimeter mm	Moment of Inertia (I)		Section Modulus (Z)		Radius of Gyration (k)	
					about x-x mm <sup>4</sup>	about y-y mm <sup>4</sup>	about x-x mm <sup>3</sup>	about y-y mm <sup>3</sup>	about x-x mm	about y-y mm
E26674	6061 T6	10.011	3707	1026	8819000	17022000	100347	101797	48.76	67.75

# Ceiling

## HALF SIZE SECTIONS

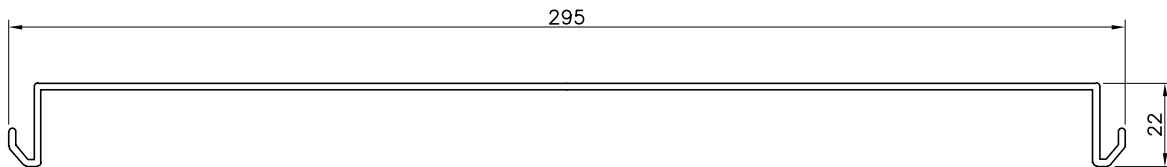

EP3546  
CEILING TRIM CLIP

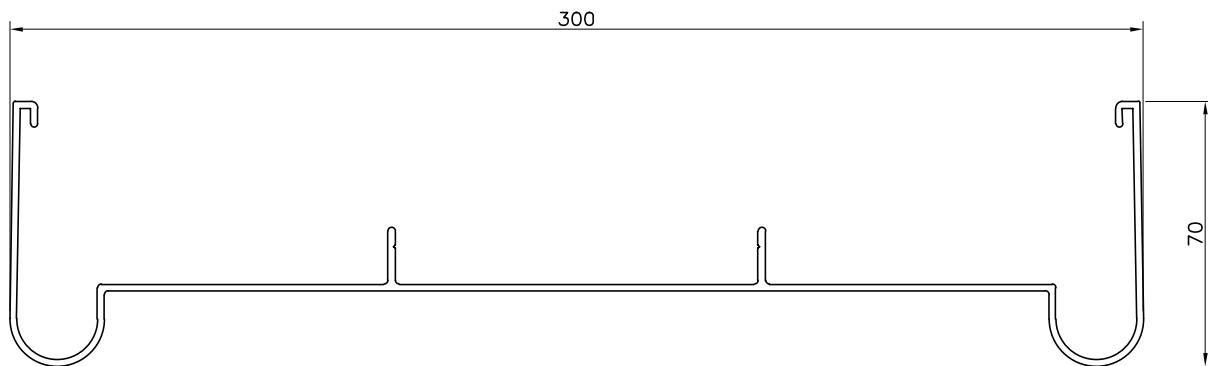

EP3559  
CEILING TRIM

Extrusion No.	Alloy/ Temper	Mass per metre kg/m	Area of Section mm <sup>2</sup>	Anodising Perimeter mm	Moment of Inertia (I)		Section Modulus (Z)		Radius of Gyration (k)	
					about x-x mm <sup>4</sup>	about y-y mm <sup>4</sup>	about x-x mm <sup>3</sup>	about y-y mm <sup>3</sup>	about x-x mm	about y-y mm
EP3546	6060 T5	1.684	624	695	20260	5708900	1087	38652	5.70	95.65
EP3559	6060 T5	2.469	914	1008	237270	10768370	5310	71789	16.11	108.54

## Air Conditioning Grille

FULL SIZE SECTIONS

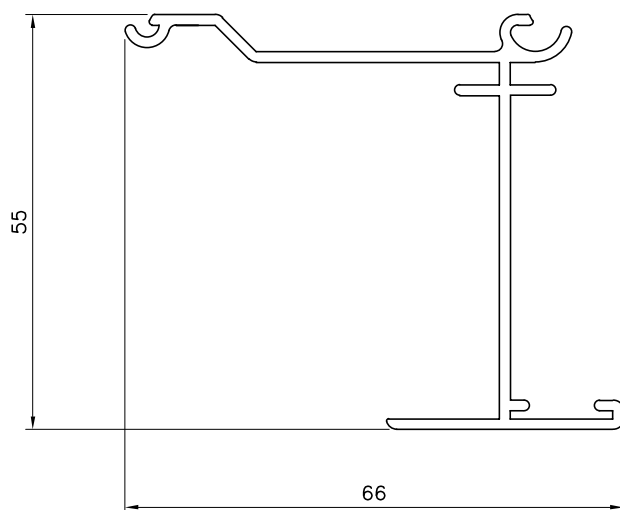

EA1129  
AIR CONDITIONING GRILLE

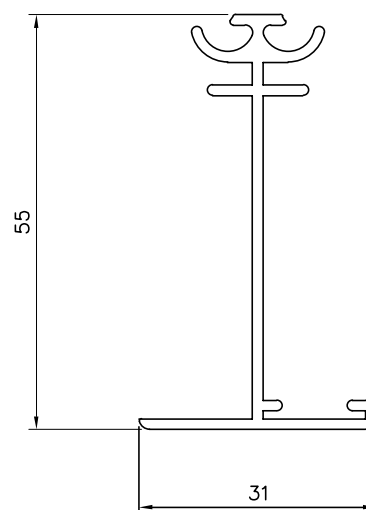

EA1130  
AIR CONDITIONING GRILLE

Extrusion No.	Alloy/ Temper	Mass per metre kg/m	Area of Section mm <sup>2</sup>	Anodising Perimeter mm	Moment of Inertia (I)		Section Modulus (Z)		Radius of Gyration (k)	
					about x-x mm <sup>4</sup>	about y-y mm <sup>4</sup>	about x-x mm <sup>3</sup>	about y-y mm <sup>3</sup>	about x-x mm	about y-y mm
EA1129	6060 T5	0.563	208	315	90660	21150	3097	447	20.88	10.08
EA1130	6060 T5	0.494	183	252	81380	5800	2892	358	21.09	5.63

## Skirting

### FULL SIZE SECTIONS

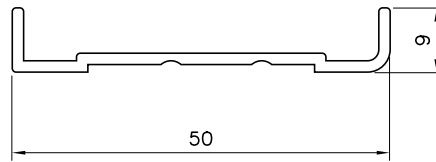

EA1254  
SKIRTING

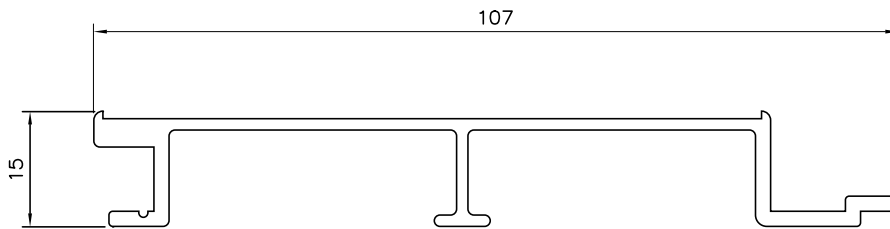

EA1252  
INTERIOR TRIM

Extrusion No.	Alloy/ Temper	Mass per metre kg/m	Area of Section mm <sup>2</sup>	Anodising Perimeter mm	Moment of Inertia (I)		Section Modulus (Z)		Radius of Gyration (k)	
					about x-x mm <sup>4</sup>	about y-y mm <sup>4</sup>	about x-x mm <sup>3</sup>	about y-y mm <sup>3</sup>	about x-x mm	about y-y mm
EA1254	6060 T5	0.257	95	132	320	27560	51	1085	1.84	17.03
EA1252	6060 T5	0.762	282	319	7700	328420	841	5712	5.23	34.13

# Louvre / Separator Frame

FULL SIZE SECTIONS

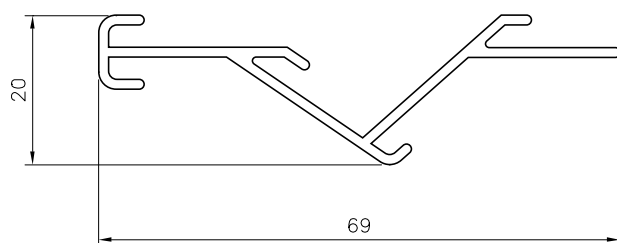

EA1148  
LOUVRE

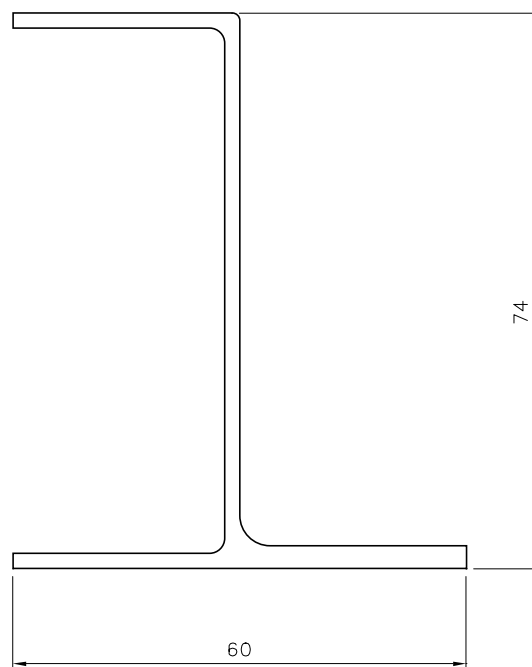

E73925  
SEPERATOR FRAME

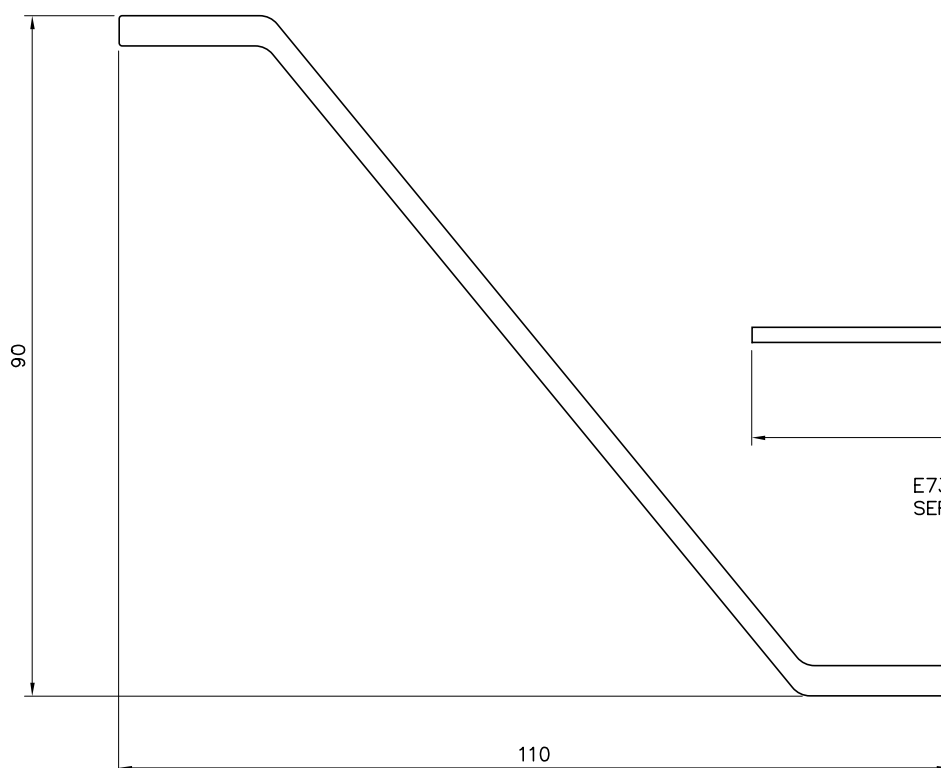

EP4974  
LOUVRE

Extrusion No.	Alloy/ Temper	Mass per metre kg/m	Area of Section mm <sup>2</sup>	Anodising Perimeter mm	Moment of Inertia (I)		Section Modulus (Z)		Radius of Gyration (k)	
					about x-x mm <sup>4</sup>	about y-y mm <sup>4</sup>	about x-x mm <sup>3</sup>	about y-y mm <sup>3</sup>	about x-x mm	about y-y mm
EA1148	6106 T6	0.421	155	234	3560	62290	316	1629	4.79	20.05
E73925	6060 T5	0.953	353	319	286000	62000	6291	1938	28.96	13.25
EP4974	6060 T5	1.326	491	308	464630	497500	8448	11056	30.76	31.83

## Hull Bowsing Line

FULL SIZE SECTIONS

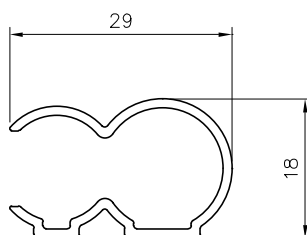

EP3759  
HULL BOWSING LINE

Extrusion No.	Alloy/ Temper	Mass per metre kg/m	Area of Section mm <sup>2</sup>	Anodising Perimeter mm	Moment of Inertia (I)		Section Modulus (Z)		Radius of Gyration (k)	
					about x-x mm <sup>4</sup>	about y-y mm <sup>4</sup>	about x-x mm <sup>3</sup>	about y-y mm <sup>3</sup>	about x-x mm	about y-y mm
EP3759	6060 T5	0.250	92	153	4300	7160	439	452	6.84	8.82